

| | | | | | |
|-----|------------|----------|----------|------------|---|
| I | 09/10/2018 | W Briggs | W Briggs | D Hopgood | Updated to incorporate WTI CIV comments 4342 (North Road Removed) |
| H | 20/07/2018 | W Briggs | W Briggs | D Hopgood | Drawing amended |
| G | 20/03/2018 | W Briggs | W Briggs | D Hopgood | Updated to incorporate WTI CIV comments 1374, 2549, 1284 |
| F | 09/10/2017 | W Briggs | W Briggs | D Hopgood | Updated drawing in line with WTI Comments Tracker Document |
| C | 10/07/2017 | W Briggs | W Briggs | D Hopgood | Updated drawing in line with WTI Comments Tracker Document |
| B | 30/03/2017 | W Briggs | W Briggs | C Fletcher | Updated drawing in line with WTI Comments Tracker Document |
| A | 14/03/2017 | W Briggs | W Briggs | C Fletcher | External Lighting Technical Submission |
| Rev | Date | Written | Checked | Approved | Subject |

PROJECT:

K3 CHP Facility

Kemsley Mill, Sittingbourne, Kent



CUSTOMER:



EPC CONTRACTOR:



SUBCONTRACTOR:



St Vincent House, Normanby Road
Scunthorpe, North Lincolnshire DN15 8QT
UNITED KINGDOM

Tel 01724 843 491
Fax 01724 867 680

CONSTRUCTION

Doc
Number

TITLE OF DOCUMENT:

EXTERNAL LIGHTING TECHNICAL SUBMISSION

| | | | | |
|------------|---|--------------------------------|--|-------------|
| Page 1 | N° document : 5025 20 02 01 17 _ LX J 0922 | | | Issue: I |
| AAK | 04 | 20 02 01 17 _ LX J 0922 | | I |
| Project N° | Type | Doc N° | | Rev |

Table of Contents**KEMSLEY EFW - EXTERNAL LIGHTING TECH SUB REV I - ISSUE 09/10/2018**

| | | |
|------------|---|----|
| 1.0 | INTRODUCTION..... | 3 |
| 2.0 | ILLUMINATION LEVELS..... | 3 |
| 3.0 | UNIFORMITY..... | 3 |
| 4.0 | LUMINAIRE SELECTION..... | 4 |
| 4.1 | LOADING/UNLOADING AREAS..... | 4 |
| 4.2 | TRANSPORT AREAS..... | 4 |
| 4.3 | CAR PARKS..... | 4 |
| 4.4 | WALKWAYS..... | 4 |
| 4.5 | STOREAGE AREAS..... | 4 |
| 4.6 | UKPN SWITCH YARD..... | 4 |
| 4.7 | IWW AND FUEL TANK..... | 5 |
| 4.8 | CHIMNEY PLATFORM AND STAIRCASE..... | 5 |
| 4.9 | ROOF AREAS..... | 5 |
| 5.0 | CONTROLS..... | 5 |
| | Main site Drawing..... | 6 |
| | Lihting Schedule | 7 |
| | Kingfisher Carina Flood Data Sheet..... | 11 |
| | Kingfisher Italo Data Sheet..... | 12 |
| | Luceco Climate Extra Data Sheet..... | 23 |
| | Lamp Post Data Sheet..... | 27 |

KEMSLEY EFW - EXTERNAL LIGHTING TECH SUB REV I - ISSUE 09/10/2018**1.0 INTRODUCTION**

Kemsley Energy from Waste is a large industrial waste recycling plant, adjacent to the Swale/Sheppey crossing. The site will be mostly industrial in nature and the external lighting installation will be predominantly to provide walkways, roadways, parking and aprons with illumination, we have taken into consideration Planning Condition No.21 which states that the external strategy needs to be submitted to the Waste Planning Authority for approval. To demonstrate the impact of light spillage onto the adjacent SPA and RAMSAR site we must extend the lux levels beyond the boundary of the SPA and RAMSAR site. Please refer to drawing ref.AAK-04-20020117_LXG0907 Rev H which is enclosed.

The purpose of this report is to highlight the key design considerations for the external lighting at the above site. All luminaires to be used externally shall be corrosion resistant to a C4 rating and will be protected against saline environments (as a minimum), and additionally protected to a minimum IP65.

2.0 ILLUMINATION LEVELS

External areas within the site boundary will be designed to conform to the employer's requirements and CIBSEs SLL Code for Lighting 2012, SLL Guide LG1 Industrial Lighting, SLL Guide LG6 Outdoor Environments, EN13201-2 for Roadways, and the requirements of BS EN12464-2 2014 for outdoor workplaces.

Where the recommended illumination standards listed in the above documentation differ those listed within the contract documentation, the contract illuminance levels will be adhered to.

Transport areas will be illuminated to category C2, horizontal illumination of 20 lux.

Pedestrian walkways shall be 5lux.

Vehicle turning, loading and unloading areas shall be 50lux.

3.0 UNIFORMITY

External areas within the site boundary will be designed to conform to the requirements of CIBSE SSL Code for Lighting 2012, SLL Guide LG1, SLL Guide LG6, and the requirements of BS EN12464-2 2014

Please refer to drawings ref.AAK-04-20020117_LXG0907 Rev H.

4.0 LUMINAIRE SELECTION

4.1 LOADING/UNLOADING

Loading bays will be illuminated with wall mounted twin head flood lights at high level, these will provide a good even spread of light and be capable of high enough outputs for the raised illumination levels required for these spaces. Refer to attached drawing for fitting type used.

4.2 TRANSPORT AREAS

Transport circulation, and roadways will be illuminated with a mixture of single and double head column mounted lanterns. Certain spaces will also be supplemented with wall/building mounted floods. Refer to attached drawing for fitting types used.

4.3 CAR PARKS

Car parking will be illuminated predominantly using wall mounted flood lighting. Where the car parking is remote from the building, columns will be positioned to achieve recommended illumination levels for site security. Refer to attached drawing for fitting types used.

4.4 WALKWAYS

External walkways, pedestrian routes, and emergency escape routes will be served by wall mounted flood lights, and wall mounted emergency escape lighting above external escape doors. Refer to attached drawing for fitting types used.

4.5 STORAGE AREAS

Storage areas, depending on the height of walls and overall size of the spaces, will be illuminated with wall mounted flood lights. External storage spaces which are adjacent the main building will be illuminated with wall mounted battens or wall mounted floods. Refer to attached drawing for fitting types used.

4.6 UKPN SWITCH YARD

The UKPN switch yard will be illuminated with 10m hinged columns which are serviceable from ground level with a mixture of single and twin floods, general security lighting will be provided switched via centralized photocell and additional lighting can be manually switched from the compound to achieve the higher 50 lux requirement as per UKPN specification.

4.7 IWW AND FUEL TANK

The IWW will be illuminated using low level LED battens and self-contained emergency LED battens mounted on unistrut which will be directional to the areas in question, these will be locally switched as and when required to minimise any unnecessary lighting spill over towards the RAMSAR site.

4.8 CHIMNEY PLATFORM AND STAIRCASE

The chimney platform and staircase will be illuminated using self-contained emergency LED battens mounted on Unistrut, these will be positioned to point away from the RAMSAR site and be manually switched locally to keep any lighting spill to an absolute minimum.

4.9 ROOF AREAS

The roof areas where there is equipment that may need to be accessed or maintained during the hours of darkness will be illuminated using a mixture of wall mounted floods, wall mounted LED battens and self-contained emergency LED battens mounted on unistruts. These will be manually switched upon entry to the roof area.

5.0 CONTROLS

All general/security external lighting shall be controlled via timeclock, and photocell (location to be agreed) arrangement, with facility for manual override provided within main site control room. IWW, fuel tank and UKPN increased lighting, chimney platform and roof areas will be switched manually locally.

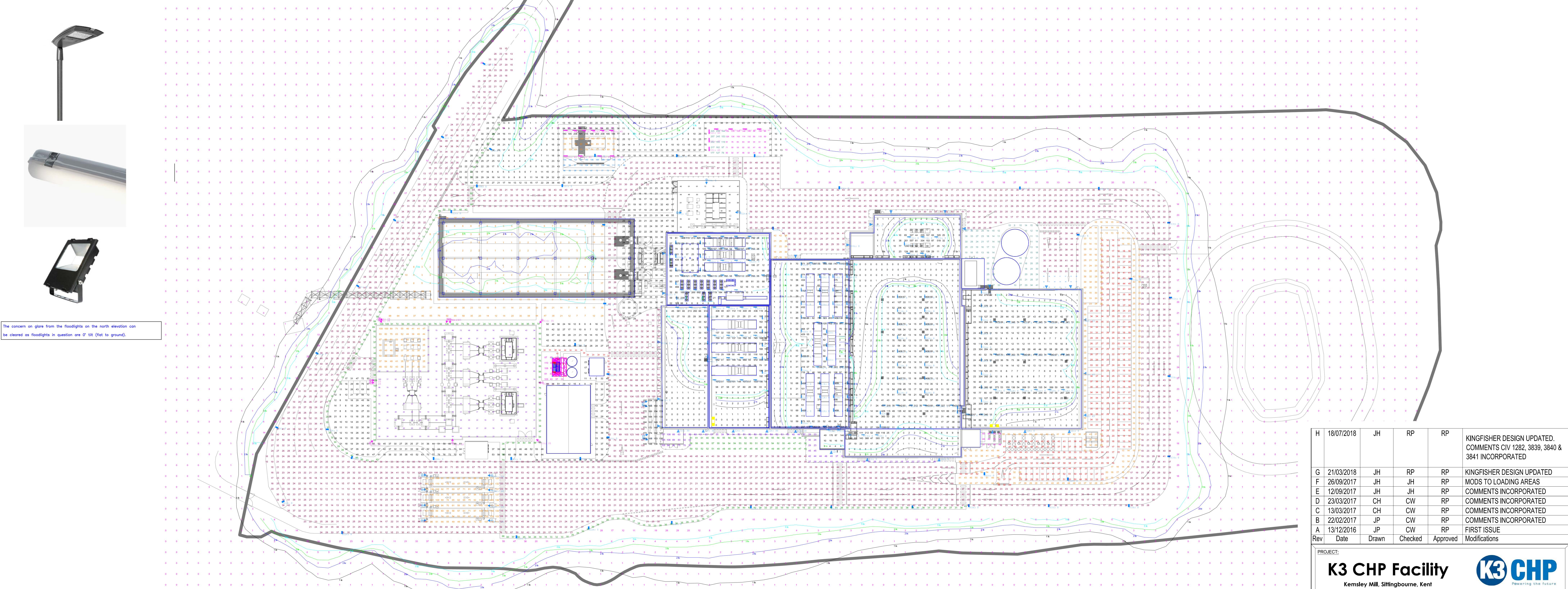
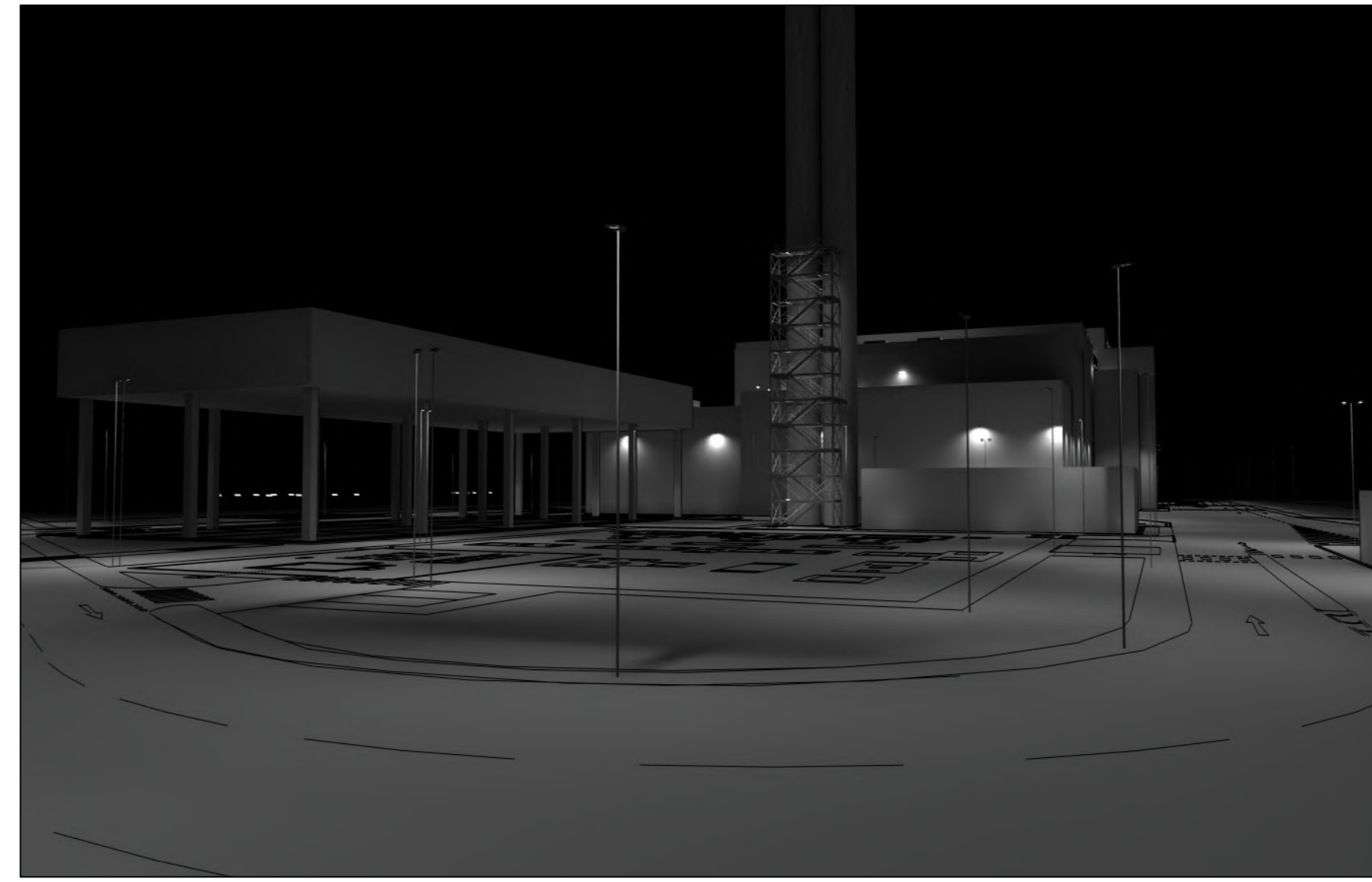
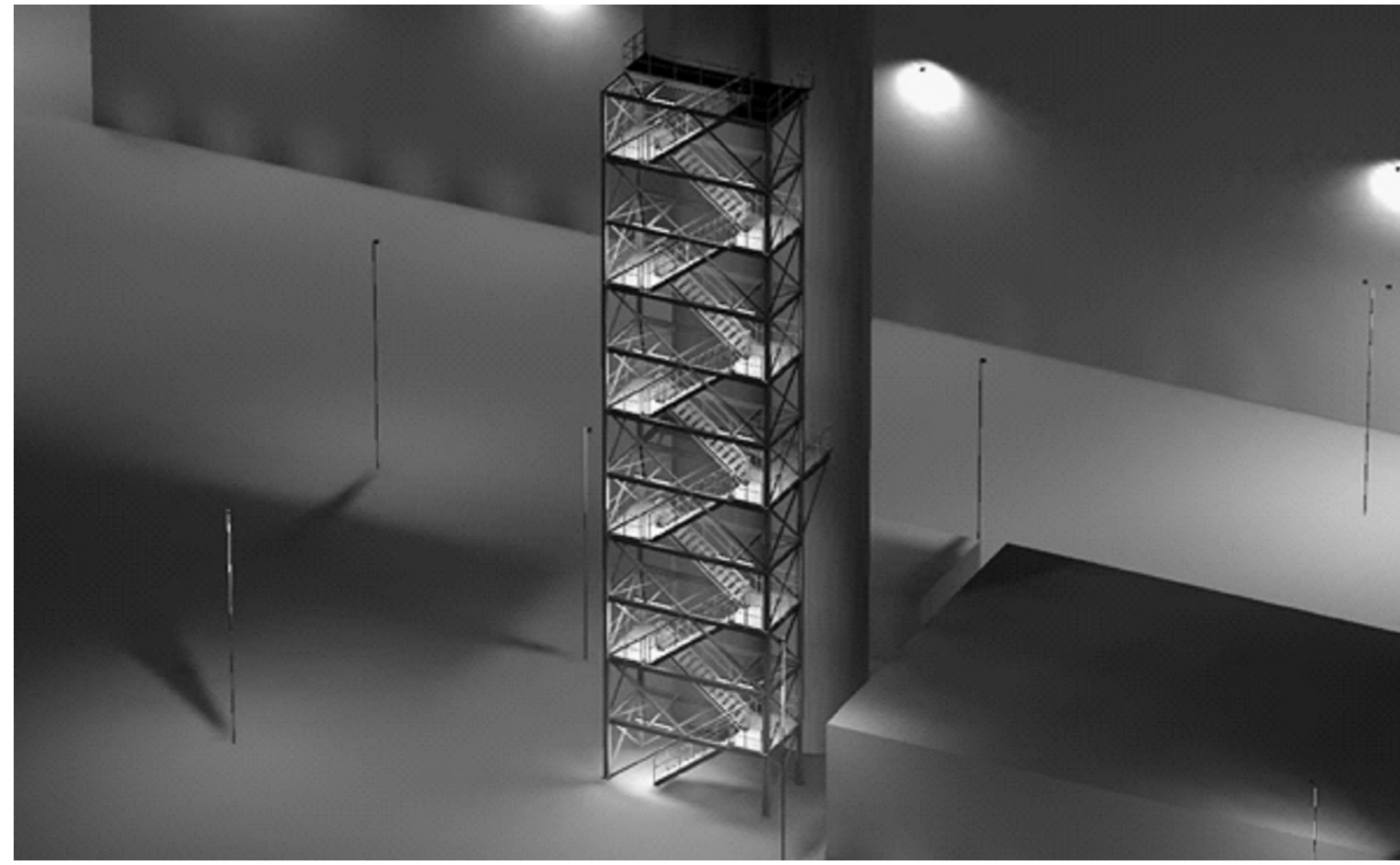

The concern on glare from the floodlights on the north elevation can be cleared as floodlights in question are 0° tilt (flat to ground).

| Label | CalcType | Units | Avg | Max | Min | Min/Avg | Min/Max | Lighting Standard |
|----------------------------------|--------------|-------|--------|-------|------|---------|---------|-------------------|
| ACC Compound | Illuminance | Lux | 46.58 | 54 | 37 | 0.79 | 0.69 | CI888 L06 |
| ACC Area | Illuminance | Lux | 10.78 | 92 | 0 | 0.00 | 0.00 | BS EN 12464 |
| ACC Walkway | Illuminance | Lux | 47.05 | 153 | 20 | 0.43 | 0.13 | CI888 L06 |
| Access Road | Illuminance | Lux | 33.84 | 172 | 11 | 0.55 | 0.26 | BS EN 12464 |
| Alcove Access Double Yanks | Illuminance | Lux | 20.27 | 41 | 9 | 0.44 | 0.22 | BS EN 12464 |
| Area in front of Boiler Building | Illuminance | Lux | 27.67 | 42 | 17 | 0.61 | 0.40 | |
| Footpaths | Illuminance | Lux | 39.92 | 159 | 11 | 0.28 | 0.10 | |
| Fuel Tank | Illuminance | Lux | 106.32 | 208 | 45 | 0.42 | 0.22 | BS EN 12464 |
| HRF Pit | Illuminance | Lux | 75.88 | 179 | 38 | 0.48 | 0.21 | BS EN 12464 |
| Loading & Unloading | Illuminance | Lux | 51.26 | 161 | 16 | 0.39 | 0.16 | BS EN 12464 |
| Loading & Unloading 2 | Illuminance | Lux | 152.42 | 174 | 119 | 0.78 | 0.68 | BS EN 12464 |
| Open Areas | Illuminance | Lux | 27.28 | 215 | 0 | 0.04 | 0.00 | |
| Ramp & Panels | Illuminance | Lux | 180.27 | 258 | 78 | 0.43 | 0.30 | BS EN 12464 |
| Roof 1 | Illuminance | Lux | 32.90 | 150 | 45 | 0.48 | 0.30 | CI888 L06 |
| Roof 2 | Illuminance | Lux | 23.96 | 164 | 0 | 0.00 | 0.00 | |
| Roof 3 | Illuminance | Lux | 43.42 | 170 | 3 | 0.07 | 0.02 | |
| Roof 4 | Illuminance | Lux | 65.82 | 194 | 0 | 0.00 | 0.00 | |
| Roof 5 | Illuminance | Lux | 72.12 | 154 | 0 | 0.00 | 0.00 | |
| Roof 6 | Illuminance | Lux | 233.65 | 157 | 0 | 0.00 | 0.00 | |
| Roof 7 | Illuminance | Lux | 157.13 | 182 | 1 | 0.01 | 0.00 | |
| Roof 8 | Illuminance | Lux | 69.84 | 158 | 0 | 0.00 | 0.00 | |
| Roof 9 | Illuminance | Lux | 128.32 | 193 | 0 | 0.00 | 0.00 | |
| Roof 10 | Illuminance | Lux | 75.60 | 207 | 13 | 0.17 | 0.05 | BS EN 12464 |
| Top Left of ACC Area | Illuminance | Lux | 46.43 | 100 | 23 | 0.50 | 0.23 | BS EN 12464 |
| Walkways | Illuminance | Lux | 97.58 | 147 | 48 | 0.49 | 0.33 | BS EN 12464 |
| Bottom Left Open Area | Illuminance | Lux | 31.46 | 103 | 14 | 0.45 | 0.14 | CI888 L06 |
| Car Park | Illuminance | Lux | 29.88 | 55 | 13 | 0.50 | 0.24 | BS 5489 |
| GR 1 | Illuminance | Lux | 23.34 | 392.9 | 0.0 | 0.00 | 0.00 | |
| GR 1 | Glare Rating | N.A. | 33.98 | 51.7 | 10.0 | 0.29 | 0.19 | |
| GR 1 | Glare Rating | N.A. | 14.85 | 46.1 | 10.0 | 0.29 | 0.18 | |
| GR 1 | Glare Rating | N.A. | 16.03 | 55.1 | 13.7 | 0.38 | 0.25 | |
| GR 1 | Glare Rating | N.A. | 34.28 | 44.3 | 10.0 | 0.29 | 0.23 | |
| GR 1 | Glare Rating | N.A. | 33.62 | 49.2 | 10.0 | 0.30 | 0.21 | |
| GR 1 | Glare Rating | N.A. | 35.39 | 53.7 | 10.0 | 0.28 | 0.19 | |
| GR 1 | Glare Rating | N.A. | 36.16 | 58.6 | 13.7 | 0.30 | 0.23 | |
| Lottery Loading & Unloading | Illuminance | Lux | 54.05 | 59 | 46 | 0.85 | 0.78 | BS EN 12464 |
| Movement Around Car Parking | Illuminance | Lux | 26.90 | 56 | 11 | 0.41 | 0.20 | CI888 L06 |
| Movement Around South Building | Illuminance | Lux | 51.17 | 137 | 18 | 0.35 | 0.13 | CI888 L06 |
| Small Open Area | Illuminance | Lux | 44.44 | 72 | 19 | 0.43 | 0.26 | CI888 L06 |

BREEAM

D29989W - Energy From Waste - Kersley Sustainable Energy Plant

| Qty | Range | Light Source | Lamp Lumens | Cutout Watts | LWFL | LOR | Luminaire Lumens | UGR | Spread Lm | RA | ARI Rev Per Day | CO2 Reduction per year | CO2 Reduction per year |
|-----|---------|----------------------|-------------|--------------|--------|--------|------------------|------|-----------|----|-----------------|------------------------|------------------------|
| 46 | 100-120 | SITEL 700MA 4 module | 1100 | 100 | 176.40 | 100.0% | 110000 | 0.0% | 0 | 30 | 11.80 | 20000 | 84.20 |
| 34 | 100-120 | SITEL 700MA 4 module | 1100 | 100 | 176.40 | 100.0% | 110000 | 0.0% | 0 | 30 | 11.80 | 20000 | 84.20 |
| 467 | 100-120 | SITEL 700MA 4 module | 1100 | 100 | 176.40 | 100.0% | 110000 | 0.0% | 0 | 30 | 11.80 | 20000 | 84.20 |

BREEAM

Part 4 Reduction of night time light pollution

| Area | Light Source | Light Intensity (cd/m²) | Lighting Standard | Building |
|------|--------------|-------------------------|-------------------|----------|
| 00 | LED | 0.00 | 0.00 | 0.00 |
| 01 | LED | 0.00 | 0.00 | 0.00 |
| 02 | LED | 0.00 | 0.00 | 0.00 |
| 03 | LED | 0.00 | 0.00 | 0.00 |
| 04 | LED | 0.00 | 0.00 | 0.00 |

| Rev | Date | Drawn | Checked | Approved | Modifications |
|-----|------------|-------|---------|----------|--|
| H | 18/07/2018 | JH | RP | RP | KINGFISHER DESIGN UPDATED. COMMENTS CIV 1282, 3839, 3840 & 3841 INCORPORATED |
| G | 21/03/2018 | JH | RP | RP | KINGFISHER DESIGN UPDATED |
| F | 26/09/2017 | JH | JH | RP | MODS TO LOADING AREAS |
| E | 12/09/2017 | JH | JH | RP | COMMENTS INCORPORATED |
| D | 23/03/2017 | CH | CW | RP | COMMENTS INCORPORATED |
| C | 13/03/2017 | CH | CW | RP | COMMENTS INCORPORATED |
| B | 22/02/2017 | JP | CW | RP | COMMENTS INCORPORATED |
| A | 13/12/2016 | JP | CW | RP | FIRST ISSUE |

PROJECT:
K3 CHP Facility
Kersley Mill, Sittingbourne, Kent

CUSTOMER:
Wheeler Technologies

EPC CONTRACTOR:
CNIM CONSTRUCTIONS
INDUSTRIELLES DE LA MEDITERRANEE

SUBCONTRACTOR:
Clugston
25 Wood House, Kersley Road, Sittingbourne, Kent

DRAWING TITLE:
EXTERNAL LIGHTING DRAWING

Format: A0 **Scale:** 1/500

DRAWING N°: 502520_02_01_12 / LX G 0907 **H**

Project N°: AAK 04 **Type:** 20 02 01 17 **Doc N°:** LX G 0907 **Rev:** H

D26989 Energy From Waste - Kemsley Sustainable Energy Plant



| Reference | Image | Description | Product Code | Output (W) | Light Source | Dimensions (LxWxH or ØxH)mm |
|-----------|---|--|-------------------|------------|--------------|-----------------------------|
| EX1 |  | Italo 1 LED lantern. Complete with 4 Trio LED modules (4M). Asymmetrical optic for street lighting (Extra Urban) STE-M, 700mA, dark grey satin finish. IP66. Non dimmable. | IT1-STE-M4.7-4M1F | 102w | LED | 615x343x253 |
| EX2 |  | Carina LED symmetrical floodlight. IP65, 150w, 15,661 lumens, 4000k | CFA150LED | 150w | LED | 550x655x205 |
| EX3 |  | Carina LED symmetrical floodlight. IP65, 150w, 15,661 lumens, 4000k | CFA150LED | 150w | LED | 550x655x205 |
| EX6 |  | Luceco Climate Extra Twin LED luminaire, IP65, 48w, natural white 4000K | LCL15066S40 | 48w | LED | 1540x90 |

D26989 Energy From Waste - Kemsley Sustainable Energy Plant



| Reference | Image | Description | Product Code | Output (W) | Light Source | Dimensions (LxWxH or ØxH)mm |
|-----------|---|---|--------------|------------|--------------|-----------------------------|
| EX6E |  | Luceco Climate Extra Twin LED luminaire, IP65, 48w, natural white 4000K | LCL15066E40 | 48w | LED | 1540x90 |
| | | | | | | |
| | | | | | | |
| | | | | | | |



Kingfisher Lighting

Datasheet

Carina

Carina is a great all-rounder with a well controlled distribution, suited to general purpose flood lighting and smaller sports applications.



Key Features

| | Source Lumens | Luminaire Lumens | Power |
|--------|------------------|------------------|--------------|
| LED | 3,300 - 16,500 | 3,097 - 15,661 | 30W - 150W |
| HPS/MH | 20,000 - 110,000 | - | 250W - 1000W |

- Efficacy 103-109 luminaire lm/W
- 4000K CRI >70
- Lifetime up to 36,000hr L70
- Stirrup bracket mounted

Applications

- Sports
- Area lighting
- Security
- Perimeter lighting
- Retail parks and outdoor retail sites
- Building lighting



Optics

Carina Asymmetrical 120°

Specification Text

The LED luminaire shall be manufactured from high pressure die-cast aluminium finished in polyester powder coating. It shall have a luminous efficacy over 100 lm/W and will be capable of producing up to 15,661 luminaire lumens at 4000K with a CRI >70. The luminaire will be rated at IP65.

Dimensions

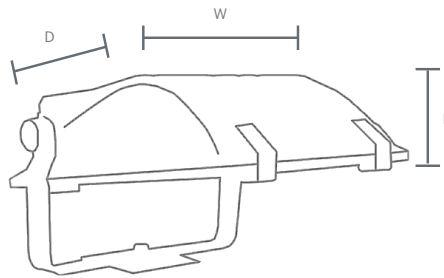

| Wattage | Body Dimensions |
|---------|-----------------|
| 30W | 220*195*65mm |
| 50W | 270*225*65mm |
| 70W | 360*275*65mm |
| 100W | 360*275*65mm |
| 150W | 430*310*85mm |

Specifications

| | |
|--------------|----------------------------|
| Weight | 1.57-5.59 kg |
| Material | Die-cast aluminium |
| Paint Finish | Anthracite grey (RAL 7016) |

| Code | Power | Light Source | Lamp Lumens | Optic | CCT(K) | IP | Weight (kg) | Paint Finish | Product Type |
|-----------|-------|--------------|-------------|-------------|--------|------|-------------|----------------------------|--------------|
| LED | | | | | | | | | |
| CFA030LED | 30W | LED | 3,097 | Symmetrical | 4000 | IP65 | 1.57 kg | Anthracite grey (RAL 7016) | - |
| CFA050LED | 50W | LED | 5,445 | | 4000 | IP65 | 2.06 kg | Anthracite grey (RAL 7016) | - |
| CFA070LED | 70W | LED | 7,628 | | 4000 | IP65 | 3.99 kg | Anthracite grey (RAL 7016) | - |
| CFA100LED | 100W | LED | 10,278 | | 4000 | IP65 | 4.10 kg | Anthracite grey (RAL 7016) | - |
| CFA150LED | 150W | LED | 15,661 | | 4000 | IP65 | 5.59 kg | Anthracite grey (RAL 7016) | - |

Accessories / Options

| Code | Description |
|--------|---------------------|
| FF/PEC | Photo-electric Cell |

Specification Text

The non-LED luminaire shall be manufactured from die-cast aluminium finished in polyester powder coating. The optical system shall consist of a formed high purity aluminium reflector. Access to optic, lamp and control gear via a quick release tool-less catch. Sealed to a minimum IP rating of IP65. The luminaire shall be insulated to Class 1 and be suitable for use with HID light sources. Options available include photo-electric cell.

Dimensions

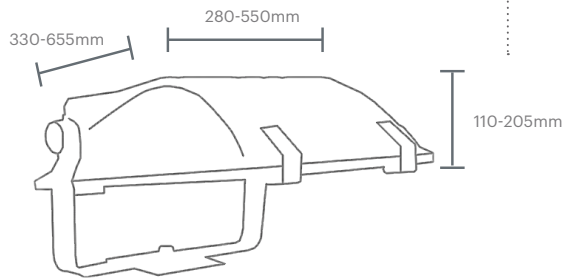

Specifications

| | |
|--------------|----------------------------|
| Weight | 10.2-29.8 kg |
| Material | Die-cast aluminium |
| Paint Finish | Anthracite grey (RAL 7016) |

| Code | Power | Light Source | Lamp Lumens | Optic | CCT(K) | IP | Weight (kg) | Paint Finish | Product Type |
|--------------|-------|--------------|-------------|-------------|--------|------|-------------|----------------------------|--------------|
| Metal Halide | | | | | | | | | |
| CFA250HKG | 250W | MH E40 | 20000 | Symmetrical | 4000 | IP65 | 10.2 kg | Anthracite Grey (RAL 7016) | - |
| CFA400HKG | 400W | MH E40 | 35000 | | 4000 | IP65 | 11.2 kg | Anthracite Grey (RAL 7016) | - |
| CFA600HKG | 600W | MH E40 | 50000 | | 4000 | IP65 | 28.0 kg | Anthracite Grey (RAL 7016) | - |
| CFA1000HKG | 1000W | MH E40 | 110000 | | 4000 | IP65 | 29.8 kg | Anthracite Grey (RAL 7016) | - |

Accessories / Options

| Code | Description |
|--------|---------------------|
| FF/PEC | Photo-electric Cell |



Kingfisher Lighting

Datasheet

Italo Street

One product, three sizes. The Italo series offers high performance functionality, versatility and a wide variety of optics. A versatile solution suitable for any street application.



Key Features

- 525mA & 700mA
- Efficacy 138 luminaire lm/W
- 4000K, CRI >70
- Lifetime >100,000hr L80
- Post Top 76mm, side entry 76mm
- Driver included

60mm post-top and side-entry spigots available. 76mm recommended. Call for further details.



Applications





- Street lighting
- Highways
- Area lighting
- Car parks
- Parks & plazas



Italo also available in urban and flood options. See separate datasheets for details.



| Fitting | | Luminaire Lumens | LED Lumens | Power | Optics |
|---------|---------|------------------|-----------------|-------------|--|
| S05 | Italo 1 | 1,520 - 8,210 | 1,841 - 9,820 | 15.5W - 76W | S05 asymmetrical suburban street optic  |
| | Italo 2 | 8,310 - 16,240 | 9,697 - 19,640 | 74W - 152W | |
| | Italo 3 | 15,280 - 31,000 | 17,455 - 36,825 | 131W - 286W | |
| STU-S | Italo 1 | 1,520 - 8,210 | 1,841 - 9,820 | 15.5W - 76W | STU-S asymmetrical suburban street optic  |
| | Italo 2 | 8,310 - 16,240 | 9,697 - 19,640 | 74W - 152W | |
| | Italo 3 | 15,280 - 31,000 | 17,455 - 36,825 | 131W - 286W | |

| Fitting | | Luminaire Lumens | LED Lumens | Power | Optics |
|---------|---------|------------------|-----------------|-------------|--|
| STU-M | Italo 1 | 1,520 - 8,210 | 1,841 - 9,820 | 15.5W - 76W | STU-M asymmetrical suburban street optic  |
| | Italo 2 | 8,310 - 16,240 | 9,697 - 19,640 | 74W - 152W | |
| | Italo 3 | 15,280 - 31,000 | 17,455 - 36,825 | 131W - 286W | |
| SV | Italo 1 | 1,520 - 8,210 | 1,841 - 9,820 | 15.5W - 76W | SV asymmetrical suburban street optic  |
| | Italo 2 | 8,310 - 16,240 | 9,697 - 19,640 | 74W - 152W | |
| | Italo 3 | 15,280 - 31,000 | 17,455 - 36,825 | 131W - 286W | |
| STE-S | Italo 1 | 2,010 - 11,270 | 2,475 - 13,200 | 20W - 102W | STE-S asymmetrical suburban street optic  |
| | Italo 2 | 11,450 - 19,030 | 13,035 - 23,100 | 98W - 183W | |
| | Italo 3 | 19,550 - 32,510 | 23,463 - 39,600 | 173W - 303W | |
| STE-M | Italo 1 | 2,010 - 11,270 | 2,475 - 13,200 | 20W - 102W | STE-M asymmetrical suburban street optic  |
| | Italo 2 | 11,450 - 16,630 | 13,035 - 19,800 | 98W - 148W | |
| | Italo 3 | 17,670 - 32,510 | 20,856 - 39,600 | 150W - 303W | |
| STW | Italo 1 | 2,010 - 11,270 | 2,475 - 13,200 | 20W - 102W | STW asymmetrical suburban street optic  |
| | Italo 2 | 11,450 - 16,630 | 13,035 - 19,800 | 98W - 148W | |
| | Italo 3 | 17,670 - 32,510 | 20,856 - 39,600 | 150W - 303W | |

Specifications

| | |
|--------------|---|
| Weight | 6.8-19 kg |
| Windage | Italo 1: 0.05-0.18m ² Italo 2: 0.08-0.3m ² Italo 3: 0.1-0.4m ² |
| Material | Die-cast aluminium |
| Paint Finish | Graphite grey |

Specification Text

The luminaire shall be manufactured from high pressure die-cast aluminium. It shall have an LED efficacy of up to 151 luminaire lm/W and will be capable of producing up to 32,510 luminaire lumens at 4000K with a CRI >70. A number of optics will be available and the luminaire will be rated at IP66 and IK09. The optical design will be a reflector-based optic with glass screen.



Dimensions

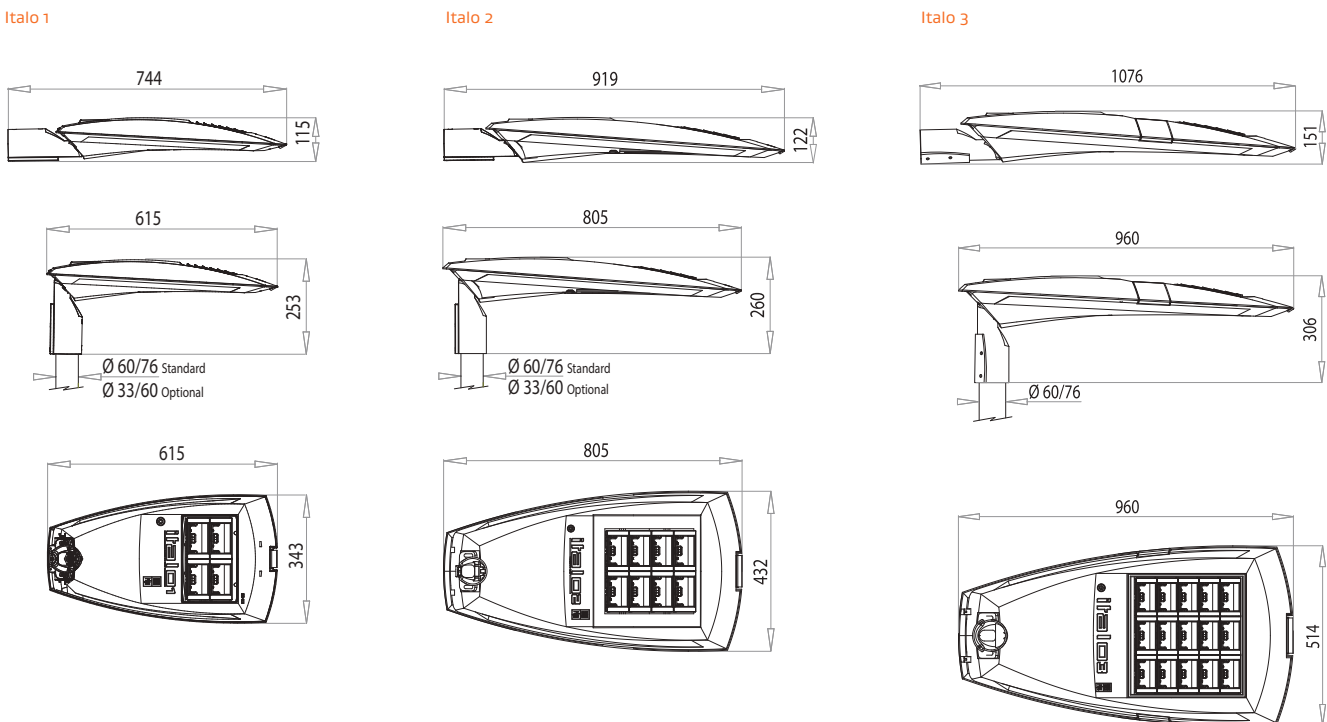

All units of measurement in mm.

| Code | Power | Light Source | Luminaire Lumens | Optic | CCT(K) | IP | IK | Weight (kg) | Paint Finish | Product Type |
|-------------------|-------|--------------|------------------|--|--------|------|-------|---------------|---------------|--------------|
| S05 Optic | | | | | | | | | | |
| IT1-SO5-4.5-1M1F | 15.5W | LED | 1520 | Asymmetrical suburban street optic (SO5) | 4000 | IP66 | IK09 | 6.80 | Graphite grey | Fixed |
| IT1-SO5-4.5-1M1D | 15.5W | LED | 1520 | | 4000 | IP66 | IK09 | 6.80 | Graphite grey | Dimmable |
| IT1-SO5-4.7-1M1F | 22W | LED | 2090 | | 4000 | IP66 | IK09 | 6.80 | Graphite grey | Fixed |
| IT1-SO5-4.7-1M1D | 22W | LED | 2090 | | 4000 | IP66 | IK09 | 6.80 | Graphite grey | Dimmable |
| IT1-SO5-4.5-2M1F | 31W | LED | 3290 | | 4000 | IP66 | IK09 | 6.80 | Graphite grey | Fixed |
| IT1-SO5-4.5-2M1D | 31W | LED | 3290 | | 4000 | IP66 | IK09 | 6.80 | Graphite grey | Dimmable |
| IT1-SO5-4.7-2M1F | 40.5W | LED | 4160 | | 4000 | IP66 | IK09 | 6.80 | Graphite grey | Fixed |
| IT1-SO5-4.7-2M1D | 40.5W | LED | 4160 | | 4000 | IP66 | IK09 | 6.80 | Graphite grey | Dimmable |
| IT1-SO5-4.5-3M1F | 44.5W | LED | 4930 | | 4000 | IP66 | IK09 | 6.80 | Graphite grey | Fixed |
| IT1-SO5-4.5-3M1D | 44.5W | LED | 4930 | | 4000 | IP66 | IK09 | 6.80 | Graphite grey | Dimmable |
| IT1-SO5-4.7-3M1F | 58W | LED | 6210 | | 4000 | IP66 | IK09 | 6.80 | Graphite grey | Fixed |
| IT1-SO5-4.7-3M1D | 58W | LED | 6210 | | 4000 | IP66 | IK09 | 6.80 | Graphite grey | Dimmable |
| IT1-SO5-4.5-4M1F | 57W | LED | 6510 | | 4000 | IP66 | IK09 | 6.80 | Graphite grey | Fixed |
| IT1-SO5-4.5-4M1D | 57W | LED | 6510 | | 4000 | IP66 | IK09 | 6.80 | Graphite grey | Dimmable |
| IT1-SO5-4.7-4M1F | 76W | LED | 8210 | | 4000 | IP66 | IK09 | 6.80 | Graphite grey | Fixed |
| IT1-SO5-4.7-4M1D | 76W | LED | 8210 | | 4000 | IP66 | IK09 | 6.80 | Graphite grey | Dimmable |
| IT2-SO5-4.5-5M1F | 74W | LED | 8310 | | 4000 | IP66 | IK09 | 12.00 | Graphite grey | Fixed |
| IT2-SO5-4.5-5M1D | 74W | LED | 8310 | | 4000 | IP66 | IK09 | 12.00 | Graphite grey | Dimmable |
| IT2-SO5-4.7-5M1F | 99W | LED | 10600 | | 4000 | IP66 | IK09 | 12.00 | Graphite grey | Fixed |
| IT2-SO5-4.7-5M1D | 99W | LED | 10600 | | 4000 | IP66 | IK09 | 12.00 | Graphite grey | Dimmable |
| IT2-SO5-4.5-6M1F | 89W | LED | 9930 | | 4000 | IP66 | IK09 | 12.00 | Graphite grey | Fixed |
| IT2-SO5-4.5-6M1D | 89W | LED | 9930 | | 4000 | IP66 | IK09 | 12.00 | Graphite grey | Dimmable |
| IT2-SO5-4.7-6M1F | 117W | LED | 12520 | | 4000 | IP66 | IK09 | 12.00 | Graphite grey | Fixed |
| IT2-SO5-4.7-6M1D | 117W | LED | 12520 | | 4000 | IP66 | IK09 | 12.00 | Graphite grey | Dimmable |
| IT2-SO5-4.5-7M1F | 104W | LED | 11440 | | 4000 | IP66 | IK09 | 12.00 | Graphite grey | Fixed |
| IT2-SO5-4.5-7M1D | 104W | LED | 11440 | | 4000 | IP66 | IK09 | 12.00 | Graphite grey | Dimmable |
| IT2-SO5-4.7-7M1F | 136W | LED | 14360 | | 4000 | IP66 | IK09 | 12.00 | Graphite grey | Fixed |
| IT2-SO5-4.7-7M1D | 136W | LED | 14360 | | 4000 | IP66 | IK09 | 12.00 | Graphite grey | Dimmable |
| IT2-SO5-4.5-8M1F | 116W | LED | 12970 | | 4000 | IP66 | IK09 | 12.00 | Graphite grey | Fixed |
| IT2-SO5-4.5-8M1D | 116W | LED | 12970 | | 4000 | IP66 | IK09 | 12.00 | Graphite grey | Dimmable |
| IT2-SO5-4.7-8M1F | 152W | LED | 16240 | | 4000 | IP66 | IK09 | 12.00 | Graphite grey | Fixed |
| IT2-SO5-4.7-8M1D | 152W | LED | 16240 | | 4000 | IP66 | IK09 | 12.00 | Graphite grey | Dimmable |
| IT3-SO5-4.5-9M1F | 131W | LED | 15280 | | 4000 | IP66 | IK09 | 19.00 | Graphite grey | Fixed |
| IT3-SO5-4.5-9M1D | 131W | LED | 15280 | | 4000 | IP66 | IK09 | 19.00 | Graphite grey | Dimmable |
| IT3-SO5-4.7-9M1F | 175W | LED | 19120 | | 4000 | IP66 | IK09 | 19.00 | Graphite grey | Fixed |
| IT3-SO5-4.7-9M1D | 175W | LED | 19120 | | 4000 | IP66 | IK09 | 19.00 | Graphite grey | Dimmable |
| IT3-SO5-4.5-10M1F | 142W | LED | 16940 | | 4000 | IP66 | IK09 | 19.00 | Graphite grey | Fixed |
| IT3-SO5-4.5-10M1D | 142W | LED | 16940 | | 4000 | IP66 | IK09 | 19.00 | Graphite grey | Dimmable |
| IT3-SO5-4.7-10M1F | 194W | LED | 21120 | | 4000 | IP66 | IK09 | 19.00 | Graphite grey | Fixed |
| IT3-SO5-4.7-10M1D | 194W | LED | 21120 | | 4000 | IP66 | IK09 | 19.00 | Graphite grey | Dimmable |
| IT3-SO5-4.5-11M1F | 157W | LED | 18540 | | 4000 | IP66 | IK09 | 19.00 | Graphite grey | Fixed |
| IT3-SO5-4.5-11M1D | 157W | LED | 18540 | | 4000 | IP66 | IK09 | 19.00 | Graphite grey | Dimmable |
| IT3-SO5-4.7-11M1F | 213W | LED | 23110 | 4000 | IP66 | IK09 | 19.00 | Graphite grey | Fixed | |
| IT3-SO5-4.7-11M1D | 213W | LED | 23110 | 4000 | IP66 | IK09 | 19.00 | Graphite grey | Dimmable | |
| IT3-SO5-4.5-12M1F | 173W | LED | 19970 | 4000 | IP66 | IK09 | 19.00 | Graphite grey | Fixed | |
| IT3-SO5-4.5-12M1D | 173W | LED | 19970 | 4000 | IP66 | IK09 | 19.00 | Graphite grey | Dimmable | |
| IT3-SO5-4.7-12M1F | 232W | LED | 25100 | 4000 | IP66 | IK09 | 19.00 | Graphite grey | Fixed | |
| IT3-SO5-4.7-12M1D | 232W | LED | 25100 | 4000 | IP66 | IK09 | 19.00 | Graphite grey | Dimmable | |
| IT3-SO5-4.5-13M1F | 188W | LED | 21660 | 4000 | IP66 | IK09 | 19.00 | Graphite grey | Fixed | |

| Code | Power | Light Source | Luminaire Lumens | Optic | CCT(K) | IP | IK | Weight (kg) | Paint Finish | Product Type | |
|---------------------|-------|--------------|------------------|--|--|------|-------|---------------|---------------|---------------|-------|
| IT3-SO5-4.5-13M1F | 188W | LED | 21660 | Asymmetrical suburban street optic (SO5) | 4000 | IP66 | IK09 | 19.00 | Graphite grey | Fixed | |
| IT3-SO5-4.5-13M1D | 188W | LED | 21660 | | 4000 | IP66 | IK09 | 19.00 | Graphite grey | Dimmable | |
| IT3-SO5-4.7-13M1F | 249W | LED | 27070 | | 4000 | IP66 | IK09 | 19.00 | Graphite grey | Fixed | |
| IT3-SO5-4.7-13M1D | 249W | LED | 27070 | | 4000 | IP66 | IK09 | 19.00 | Graphite grey | Dimmable | |
| IT3-SO5-4.5-14M1F | 201W | LED | 23450 | | 4000 | IP66 | IK09 | 19.00 | Graphite grey | Fixed | |
| IT3-SO5-4.5-14M1D | 201W | LED | 23450 | | 4000 | IP66 | IK09 | 19.00 | Graphite grey | Dimmable | |
| IT3-SO5-4.7-14M1F | 267W | LED | 29040 | | 4000 | IP66 | IK09 | 19.00 | Graphite grey | Fixed | |
| IT3-SO5-4.7-14M1D | 267W | LED | 29040 | | 4000 | IP66 | IK09 | 19.00 | Graphite grey | Dimmable | |
| IT3-SO5-4.5-15M1F | 215W | LED | 25030 | | 4000 | IP66 | IK09 | 19.00 | Graphite grey | Fixed | |
| IT3-SO5-4.5-15M1D | 215W | LED | 25030 | | 4000 | IP66 | IK09 | 19.00 | Graphite grey | Dimmable | |
| IT3-SO5-4.7-15M1F | 286W | LED | 31000 | | 4000 | IP66 | IK09 | 19.00 | Graphite grey | Fixed | |
| IT3-SO5-4.7-15M1D | 286W | LED | 31000 | | 4000 | IP66 | IK09 | 19.00 | Graphite grey | Dimmable | |
| STU-S Optic | | | | | | | | | | | |
| IT1-STU-S-4.5-1M1F | 15.5W | LED | 1520 | | Asymmetrical suburban street optic (STU-S) | 4000 | IP66 | IK09 | 6.80 | Graphite grey | Fixed |
| IT1-STU-S-4.5-1M1D | 15.5W | LED | 1520 | 4000 | | IP66 | IK09 | 6.80 | Graphite grey | Dimmable | |
| IT1-STU-S-4.7-1M1F | 22W | LED | 2090 | 4000 | | IP66 | IK09 | 6.80 | Graphite grey | Fixed | |
| IT1-STU-S-4.7-1M1D | 22W | LED | 2090 | 4000 | | IP66 | IK09 | 6.80 | Graphite grey | Dimmable | |
| IT1-STU-S-4.5-2M1F | 31W | LED | 3290 | 4000 | | IP66 | IK09 | 6.80 | Graphite grey | Fixed | |
| IT1-STU-S-4.5-2M1D | 31W | LED | 3290 | 4000 | | IP66 | IK09 | 6.80 | Graphite grey | Dimmable | |
| IT1-STU-S-4.7-2M1F | 40.5W | LED | 4160 | 4000 | | IP66 | IK09 | 6.80 | Graphite grey | Fixed | |
| IT1-STU-S-4.7-2M1D | 40.5W | LED | 4160 | 4000 | | IP66 | IK09 | 6.80 | Graphite grey | Dimmable | |
| IT1-STU-S-4.5-3M1F | 44.5W | LED | 4930 | 4000 | | IP66 | IK09 | 6.80 | Graphite grey | Fixed | |
| IT1-STU-S-4.5-3M1D | 44.5W | LED | 4930 | 4000 | | IP66 | IK09 | 6.80 | Graphite grey | Dimmable | |
| IT1-STU-S-4.7-3M1F | 58W | LED | 6210 | 4000 | | IP66 | IK09 | 6.80 | Graphite grey | Fixed | |
| IT1-STU-S-4.7-3M1D | 58W | LED | 6210 | 4000 | | IP66 | IK09 | 6.80 | Graphite grey | Dimmable | |
| IT1-STU-S-4.5-4M1F | 57W | LED | 6510 | 4000 | | IP66 | IK09 | 6.80 | Graphite grey | Fixed | |
| IT1-STU-S-4.5-4M1D | 57W | LED | 6510 | 4000 | | IP66 | IK09 | 6.80 | Graphite grey | Dimmable | |
| IT1-STU-S-4.7-4M1F | 76W | LED | 8210 | 4000 | | IP66 | IK09 | 6.80 | Graphite grey | Fixed | |
| IT1-STU-S-4.7-4M1D | 76W | LED | 8210 | 4000 | | IP66 | IK09 | 6.80 | Graphite grey | Dimmable | |
| IT2-STU-S-4.5-5M1F | 74W | LED | 8310 | 4000 | | IP66 | IK09 | 12.00 | Graphite grey | Fixed | |
| IT2-STU-S-4.5-5M1D | 74W | LED | 8310 | 4000 | | IP66 | IK09 | 12.00 | Graphite grey | Dimmable | |
| IT2-STU-S-4.7-5M1F | 99W | LED | 10600 | 4000 | | IP66 | IK09 | 12.00 | Graphite grey | Fixed | |
| IT2-STU-S-4.7-5M1D | 99W | LED | 10600 | 4000 | | IP66 | IK09 | 12.00 | Graphite grey | Dimmable | |
| IT2-STU-S-4.5-6M1F | 89W | LED | 9930 | 4000 | | IP66 | IK09 | 12.00 | Graphite grey | Fixed | |
| IT2-STU-S-4.5-6M1D | 89W | LED | 9930 | 4000 | | IP66 | IK09 | 12.00 | Graphite grey | Dimmable | |
| IT2-STU-S-4.7-6M1F | 117W | LED | 12520 | 4000 | | IP66 | IK09 | 12.00 | Graphite grey | Fixed | |
| IT2-STU-S-4.7-6M1D | 117W | LED | 12520 | 4000 | | IP66 | IK09 | 12.00 | Graphite grey | Dimmable | |
| IT2-STU-S-4.5-7M1F | 104W | LED | 11440 | 4000 | | IP66 | IK09 | 12.00 | Graphite grey | Fixed | |
| IT2-STU-S-4.5-7M1D | 104W | LED | 11440 | 4000 | | IP66 | IK09 | 12.00 | Graphite grey | Dimmable | |
| IT2-STU-S-4.7-7M1F | 136W | LED | 14360 | 4000 | | IP66 | IK09 | 12.00 | Graphite grey | Fixed | |
| IT2-STU-S-4.7-7M1D | 136W | LED | 14360 | 4000 | | IP66 | IK09 | 12.00 | Graphite grey | Dimmable | |
| IT2-STU-S-4.5-8M1F | 116W | LED | 12970 | 4000 | | IP66 | IK09 | 12.00 | Graphite grey | Fixed | |
| IT2-STU-S-4.5-8M1D | 116W | LED | 12970 | 4000 | | IP66 | IK09 | 12.00 | Graphite grey | Dimmable | |
| IT2-STU-S-4.7-8M1F | 152W | LED | 16240 | 4000 | | IP66 | IK09 | 12.00 | Graphite grey | Fixed | |
| IT2-STU-S-4.7-8M1D | 152W | LED | 16240 | 4000 | | IP66 | IK09 | 12.00 | Graphite grey | Dimmable | |
| IT3-STU-S-4.5-9M1F | 131W | LED | 15280 | 4000 | | IP66 | IK09 | 19.00 | Graphite grey | Fixed | |
| IT3-STU-S-4.5-9M1D | 131W | LED | 15280 | 4000 | | IP66 | IK09 | 19.00 | Graphite grey | Dimmable | |
| IT3-STU-S-4.7-9M1F | 175W | LED | 19120 | 4000 | IP66 | IK09 | 19.00 | Graphite grey | Fixed | | |
| IT3-STU-S-4.7-9M1D | 175W | LED | 19120 | 4000 | IP66 | IK09 | 19.00 | Graphite grey | Dimmable | | |
| IT3-STU-S-4.5-10M1F | 142W | LED | 16940 | 4000 | IP66 | IK09 | 19.00 | Graphite grey | Fixed | | |

| Code | Power | Light Source | Luminaire Lumens | Optic | CCT(K) | IP | IK | Weight (kg) | Paint Finish | Product Type |
|---------------------|-------|--------------|------------------|--|--------|------|-------|---------------|---------------|--------------|
| IT3-STU-S-4.5-10M1D | 142W | LED | 16940 | Asymmetrical suburban street optic (STU-S) | 4000 | IP66 | IK09 | 19.00 | Graphite grey | Dimmable |
| IT3-STU-S-4.7-10M1F | 194W | LED | 21120 | | 4000 | IP66 | IK09 | 19.00 | Graphite grey | Fixed |
| IT3-STU-S-4.7-10M1D | 194W | LED | 21120 | | 4000 | IP66 | IK09 | 19.00 | Graphite grey | Dimmable |
| IT3-STU-S-4.5-11M1F | 157W | LED | 18540 | | 4000 | IP66 | IK09 | 19.00 | Graphite grey | Fixed |
| IT3-STU-S-4.5-11M1D | 157W | LED | 18540 | | 4000 | IP66 | IK09 | 19.00 | Graphite grey | Dimmable |
| IT3-STU-S-4.7-11M1F | 213W | LED | 23110 | | 4000 | IP66 | IK09 | 19.00 | Graphite grey | Fixed |
| IT3-STU-S-4.7-11M1D | 213W | LED | 23110 | | 4000 | IP66 | IK09 | 19.00 | Graphite grey | Dimmable |
| IT3-STU-S-4.5-12M1F | 173W | LED | 19970 | | 4000 | IP66 | IK09 | 19.00 | Graphite grey | Fixed |
| IT3-STU-S-4.5-12M1D | 173W | LED | 19970 | | 4000 | IP66 | IK09 | 19.00 | Graphite grey | Dimmable |
| IT3-STU-S-4.7-12M1F | 232W | LED | 25100 | | 4000 | IP66 | IK09 | 19.00 | Graphite grey | Fixed |
| IT3-STU-S-4.7-12M1D | 232W | LED | 25100 | | 4000 | IP66 | IK09 | 19.00 | Graphite grey | Dimmable |
| IT3-STU-S-4.5-13M1F | 188W | LED | 21660 | | 4000 | IP66 | IK09 | 19.00 | Graphite grey | Fixed |
| IT3-STU-S-4.5-13M1D | 188W | LED | 21660 | | 4000 | IP66 | IK09 | 19.00 | Graphite grey | Dimmable |
| IT3-STU-S-4.7-13M1F | 249W | LED | 27070 | | 4000 | IP66 | IK09 | 19.00 | Graphite grey | Fixed |
| IT3-STU-S-4.7-13M1D | 249W | LED | 27070 | | 4000 | IP66 | IK09 | 19.00 | Graphite grey | Dimmable |
| IT3-STU-S-4.5-14M1F | 201W | LED | 23450 | | 4000 | IP66 | IK09 | 19.00 | Graphite grey | Fixed |
| IT3-STU-S-4.5-14M1D | 201W | LED | 23450 | | 4000 | IP66 | IK09 | 19.00 | Graphite grey | Dimmable |
| IT3-STU-S-4.7-14M1F | 267W | LED | 29040 | | 4000 | IP66 | IK09 | 19.00 | Graphite grey | Fixed |
| IT3-STU-S-4.7-14M1D | 267W | LED | 29040 | | 4000 | IP66 | IK09 | 19.00 | Graphite grey | Dimmable |
| IT3-STU-S-4.5-15M1F | 215W | LED | 25030 | | 4000 | IP66 | IK09 | 19.00 | Graphite grey | Fixed |
| IT3-STU-S-4.5-15M1D | 215W | LED | 25030 | | 4000 | IP66 | IK09 | 19.00 | Graphite grey | Dimmable |
| IT3-STU-S-4.7-15M1F | 286W | LED | 31000 | | 4000 | IP66 | IK09 | 19.00 | Graphite grey | Fixed |
| IT3-STU-S-4.7-15M1D | 286W | LED | 31000 | | 4000 | IP66 | IK09 | 19.00 | Graphite grey | Dimmable |
| STU-M Optic | | | | | | | | | | |
| IT1-STU-M-4.5-1M1F | 15.5W | LED | 1520 | Asymmetrical suburban street optic (STU-M) | 4000 | IP66 | IK09 | 6.80 | Graphite grey | Fixed |
| IT1-STU-M-4.5-1M1D | 15.5W | LED | 1520 | | 4000 | IP66 | IK09 | 6.80 | Graphite grey | Dimmable |
| IT1-STU-M-4.7-1M1F | 22W | LED | 2090 | | 4000 | IP66 | IK09 | 6.80 | Graphite grey | Fixed |
| IT1-STU-M-4.7-1M1D | 22W | LED | 2090 | | 4000 | IP66 | IK09 | 6.80 | Graphite grey | Dimmable |
| IT1-STU-M-4.5-2M1F | 31W | LED | 3290 | | 4000 | IP66 | IK09 | 6.80 | Graphite grey | Fixed |
| IT1-STU-M-4.5-2M1D | 31W | LED | 3290 | | 4000 | IP66 | IK09 | 6.80 | Graphite grey | Dimmable |
| IT1-STU-M-4.7-2M1F | 40.5W | LED | 4160 | | 4000 | IP66 | IK09 | 6.80 | Graphite grey | Fixed |
| IT1-STU-M-4.7-2M1D | 40.5W | LED | 4160 | | 4000 | IP66 | IK09 | 6.80 | Graphite grey | Dimmable |
| IT1-STU-M-4.5-3M1F | 44.5W | LED | 4930 | | 4000 | IP66 | IK09 | 6.80 | Graphite grey | Fixed |
| IT1-STU-M-4.5-3M1D | 44.5W | LED | 4930 | | 4000 | IP66 | IK09 | 6.80 | Graphite grey | Dimmable |
| IT1-STU-M-4.7-3M1F | 58W | LED | 6210 | | 4000 | IP66 | IK09 | 6.80 | Graphite grey | Fixed |
| IT1-STU-M-4.7-3M1D | 58W | LED | 6210 | | 4000 | IP66 | IK09 | 6.80 | Graphite grey | Dimmable |
| IT1-STU-M-4.5-4M1F | 57W | LED | 6510 | | 4000 | IP66 | IK09 | 6.80 | Graphite grey | Fixed |
| IT1-STU-M-4.5-4M1D | 57W | LED | 6510 | | 4000 | IP66 | IK09 | 6.80 | Graphite grey | Dimmable |
| IT1-STU-M-4.7-4M1F | 76W | LED | 8210 | | 4000 | IP66 | IK09 | 6.80 | Graphite grey | Fixed |
| IT1-STU-M-4.7-4M1D | 76W | LED | 8210 | | 4000 | IP66 | IK09 | 6.80 | Graphite grey | Dimmable |
| IT2-STU-M-4.5-5M1F | 74W | LED | 8310 | | 4000 | IP66 | IK09 | 12.00 | Graphite grey | Fixed |
| IT2-STU-M-4.5-5M1D | 74W | LED | 8310 | | 4000 | IP66 | IK09 | 12.00 | Graphite grey | Dimmable |
| IT2-STU-M-4.7-5M1F | 99W | LED | 10600 | | 4000 | IP66 | IK09 | 12.00 | Graphite grey | Fixed |
| IT2-STU-M-4.7-5M1D | 99W | LED | 10600 | | 4000 | IP66 | IK09 | 12.00 | Graphite grey | Dimmable |
| IT2-STU-M-4.5-6M1F | 89W | LED | 9930 | | 4000 | IP66 | IK09 | 12.00 | Graphite grey | Fixed |
| IT2-STU-M-4.5-6M1D | 89W | LED | 9930 | | 4000 | IP66 | IK09 | 12.00 | Graphite grey | Dimmable |
| IT2-STU-M-4.7-6M1F | 117W | LED | 12520 | | 4000 | IP66 | IK09 | 12.00 | Graphite grey | Fixed |
| IT2-STU-M-4.7-6M1D | 117W | LED | 12520 | | 4000 | IP66 | IK09 | 12.00 | Graphite grey | Dimmable |
| IT2-STU-M-4.5-7M1F | 104W | LED | 11440 | 4000 | IP66 | IK09 | 12.00 | Graphite grey | Fixed | |
| IT2-STU-M-4.5-7M1D | 104W | LED | 11440 | 4000 | IP66 | IK09 | 12.00 | Graphite grey | Dimmable | |

| Code | Power | Light Source | Luminaire Lumens | Optic | CCT(K) | IP | IK | Weight (kg) | Paint Finish | Product Type |
|---------------------|-------|--------------|------------------|--|--------|------|-------|---------------|---------------|--------------|
| IT2-STU-M-4.7-7M1F | 136W | LED | 14360 | Asymmetrical suburban street optic (STU-M) | 4000 | IP66 | IK09 | 12.00 | Graphite grey | Fixed |
| IT2-STU-M-4.7-7M1D | 136W | LED | 14360 | | 4000 | IP66 | IK09 | 12.00 | Graphite grey | Dimmable |
| IT2-STU-M-4.5-8M1F | 116W | LED | 12970 | | 4000 | IP66 | IK09 | 12.00 | Graphite grey | Fixed |
| IT2-STU-M-4.5-8M1D | 116W | LED | 12970 | | 4000 | IP66 | IK09 | 12.00 | Graphite grey | Dimmable |
| IT2-STU-M-4.7-8M1F | 152W | LED | 16240 | | 4000 | IP66 | IK09 | 12.00 | Graphite grey | Fixed |
| IT2-STU-M-4.7-8M1D | 152W | LED | 16240 | | 4000 | IP66 | IK09 | 12.00 | Graphite grey | Dimmable |
| IT3-STU-M-4.5-9M1F | 131W | LED | 15280 | | 4000 | IP66 | IK09 | 19.00 | Graphite grey | Fixed |
| IT3-STU-M-4.5-9M1D | 131W | LED | 15280 | | 4000 | IP66 | IK09 | 19.00 | Graphite grey | Dimmable |
| IT3-STU-M-4.7-9M1F | 175W | LED | 19120 | | 4000 | IP66 | IK09 | 19.00 | Graphite grey | Fixed |
| IT3-STU-M-4.7-9M1D | 175W | LED | 19120 | | 4000 | IP66 | IK09 | 19.00 | Graphite grey | Dimmable |
| IT3-STU-M-4.5-10M1F | 142W | LED | 16940 | | 4000 | IP66 | IK09 | 19.00 | Graphite grey | Fixed |
| IT3-STU-M-4.5-10M1D | 142W | LED | 16940 | | 4000 | IP66 | IK09 | 19.00 | Graphite grey | Dimmable |
| IT3-STU-M-4.7-10M1F | 194W | LED | 21120 | | 4000 | IP66 | IK09 | 19.00 | Graphite grey | Fixed |
| IT3-STU-M-4.7-10M1D | 194W | LED | 21120 | | 4000 | IP66 | IK09 | 19.00 | Graphite grey | Dimmable |
| IT3-STU-M-4.5-11M1F | 157W | LED | 18540 | | 4000 | IP66 | IK09 | 19.00 | Graphite grey | Fixed |
| IT3-STU-M-4.5-11M1D | 157W | LED | 18540 | | 4000 | IP66 | IK09 | 19.00 | Graphite grey | Dimmable |
| IT3-STU-M-4.7-11M1F | 213W | LED | 23110 | | 4000 | IP66 | IK09 | 19.00 | Graphite grey | Fixed |
| IT3-STU-M-4.7-11M1D | 213W | LED | 23110 | | 4000 | IP66 | IK09 | 19.00 | Graphite grey | Dimmable |
| IT3-STU-M-4.5-12M1F | 173W | LED | 19970 | | 4000 | IP66 | IK09 | 19.00 | Graphite grey | Fixed |
| IT3-STU-M-4.5-12M1D | 173W | LED | 19970 | | 4000 | IP66 | IK09 | 19.00 | Graphite grey | Dimmable |
| IT3-STU-M-4.7-12M1F | 232W | LED | 25100 | | 4000 | IP66 | IK09 | 19.00 | Graphite grey | Fixed |
| IT3-STU-M-4.7-12M1D | 232W | LED | 25100 | | 4000 | IP66 | IK09 | 19.00 | Graphite grey | Dimmable |
| IT3-STU-M-4.5-13M1F | 188W | LED | 21660 | | 4000 | IP66 | IK09 | 19.00 | Graphite grey | Fixed |
| IT3-STU-M-4.5-13M1D | 188W | LED | 21660 | | 4000 | IP66 | IK09 | 19.00 | Graphite grey | Dimmable |
| IT3-STU-M-4.7-13M1F | 249W | LED | 27070 | | 4000 | IP66 | IK09 | 19.00 | Graphite grey | Fixed |
| IT3-STU-M-4.7-13M1D | 249W | LED | 27070 | | 4000 | IP66 | IK09 | 19.00 | Graphite grey | Dimmable |
| IT3-STU-M-4.5-14M1F | 201W | LED | 23450 | | 4000 | IP66 | IK09 | 19.00 | Graphite grey | Fixed |
| IT3-STU-M-4.5-14M1D | 201W | LED | 23450 | | 4000 | IP66 | IK09 | 19.00 | Graphite grey | Dimmable |
| IT3-STU-M-4.7-14M1F | 267W | LED | 29040 | | 4000 | IP66 | IK09 | 19.00 | Graphite grey | Fixed |
| IT3-STU-M-4.7-14M1D | 267W | LED | 29040 | | 4000 | IP66 | IK09 | 19.00 | Graphite grey | Dimmable |
| IT3-STU-M-4.5-15M1F | 215W | LED | 25030 | | 4000 | IP66 | IK09 | 19.00 | Graphite grey | Fixed |
| IT3-STU-M-4.5-15M1D | 215W | LED | 25030 | | 4000 | IP66 | IK09 | 19.00 | Graphite grey | Dimmable |
| IT3-STU-M-4.7-15M1F | 286W | LED | 31000 | | 4000 | IP66 | IK09 | 19.00 | Graphite grey | Fixed |
| IT3-STU-M-4.7-15M1D | 286W | LED | 31000 | 4000 | IP66 | IK09 | 19.00 | Graphite grey | Dimmable | |
| SV Optic | | | | | | | | | | |
| IT1-SV-4.5-1M1F | 15.5W | LED | 1520 | Asymmetrical suburban street optic (SV) | 4000 | IP66 | IK09 | 6.80 | Graphite grey | Fixed |
| IT1-SV-4.5-1M1D | 15.5W | LED | 1520 | | 4000 | IP66 | IK09 | 6.80 | Graphite grey | Dimmable |
| IT1-SV-4.7-1M1F | 22W | LED | 2090 | | 4000 | IP66 | IK09 | 6.80 | Graphite grey | Fixed |
| IT1-SV-4.7-1M1D | 22W | LED | 2090 | | 4000 | IP66 | IK09 | 6.80 | Graphite grey | Dimmable |
| IT1-SV-4.5-2M1F | 31W | LED | 3290 | | 4000 | IP66 | IK09 | 6.80 | Graphite grey | Fixed |
| IT1-SV-4.5-2M1D | 31W | LED | 3290 | | 4000 | IP66 | IK09 | 6.80 | Graphite grey | Dimmable |
| IT1-SV-4.7-2M1F | 40.5W | LED | 4160 | | 4000 | IP66 | IK09 | 6.80 | Graphite grey | Fixed |
| IT1-SV-4.7-2M1D | 40.5W | LED | 4160 | | 4000 | IP66 | IK09 | 6.80 | Graphite grey | Dimmable |
| IT1-SV-4.5-3M1F | 44.5W | LED | 4930 | | 4000 | IP66 | IK09 | 6.80 | Graphite grey | Fixed |
| IT1-SV-4.5-3M1D | 44.5W | LED | 4930 | | 4000 | IP66 | IK09 | 6.80 | Graphite grey | Dimmable |
| IT1-SV-4.7-3M1F | 58W | LED | 6210 | | 4000 | IP66 | IK09 | 6.80 | Graphite grey | Fixed |
| IT1-SV-4.7-3M1D | 58W | LED | 6210 | | 4000 | IP66 | IK09 | 6.80 | Graphite grey | Dimmable |
| IT1-SV-4.5-4M1F | 57W | LED | 6510 | | 4000 | IP66 | IK09 | 6.80 | Graphite grey | Fixed |
| IT1-SV-4.5-4M1D | 57W | LED | 6510 | | 4000 | IP66 | IK09 | 6.80 | Graphite grey | Dimmable |
| IT1-SV-4.7-4M1F | 76W | LED | 8210 | | 4000 | IP66 | IK09 | 6.80 | Graphite grey | Fixed |

| Code | Power | Light Source | Luminaire Lumens | Optic | CCT(K) | IP | IK | Weight (kg) | Paint Finish | Product Type |
|--------------------|-------|--------------|------------------|--|--------|------|-------|---------------|---------------|--------------|
| IT1-SV-4.7-4M1D | 76W | LED | 8210 | Asymmetrical suburban street optic (SV) | 4000 | IP66 | IK09 | 6.80 | Graphite grey | Dimmable |
| IT2-SV-4.5-5M1F | 74W | LED | 8310 | | 4000 | IP66 | IK09 | 12.00 | Graphite grey | Fixed |
| IT2-SV-4.5-5M1D | 74W | LED | 8310 | | 4000 | IP66 | IK09 | 12.00 | Graphite grey | Dimmable |
| IT2-SV-4.7-5M1F | 99W | LED | 10600 | | 4000 | IP66 | IK09 | 12.00 | Graphite grey | Fixed |
| IT2-SV-4.7-5M1D | 99W | LED | 10600 | | 4000 | IP66 | IK09 | 12.00 | Graphite grey | Dimmable |
| IT2-SV-4.5-6M1F | 89W | LED | 9930 | | 4000 | IP66 | IK09 | 12.00 | Graphite grey | Fixed |
| IT2-SV-4.5-6M1D | 89W | LED | 9930 | | 4000 | IP66 | IK09 | 12.00 | Graphite grey | Dimmable |
| IT2-SV-4.7-6M1F | 117W | LED | 12520 | | 4000 | IP66 | IK09 | 12.00 | Graphite grey | Fixed |
| IT2-SV-4.7-6M1D | 117W | LED | 12520 | | 4000 | IP66 | IK09 | 12.00 | Graphite grey | Dimmable |
| IT2-SV-4.5-7M1F | 104W | LED | 11440 | | 4000 | IP66 | IK09 | 12.00 | Graphite grey | Fixed |
| IT2-SV-4.5-7M1D | 104W | LED | 11440 | | 4000 | IP66 | IK09 | 12.00 | Graphite grey | Dimmable |
| IT2-SV-4.7-7M1F | 136W | LED | 14360 | | 4000 | IP66 | IK09 | 12.00 | Graphite grey | Fixed |
| IT2-SV-4.7-7M1D | 136W | LED | 14360 | | 4000 | IP66 | IK09 | 12.00 | Graphite grey | Dimmable |
| IT2-SV-4.5-8M1F | 116W | LED | 12970 | | 4000 | IP66 | IK09 | 12.00 | Graphite grey | Fixed |
| IT2-SV-4.5-8M1D | 116W | LED | 12970 | | 4000 | IP66 | IK09 | 12.00 | Graphite grey | Dimmable |
| IT2-SV-4.7-8M1F | 152W | LED | 16240 | | 4000 | IP66 | IK09 | 12.00 | Graphite grey | Fixed |
| IT2-SV-4.7-8M1D | 152W | LED | 16240 | | 4000 | IP66 | IK09 | 12.00 | Graphite grey | Dimmable |
| IT3-SV-4.5-9M1F | 131W | LED | 15280 | | 4000 | IP66 | IK09 | 19.00 | Graphite grey | Fixed |
| IT3-SV-4.5-9M1D | 131W | LED | 15280 | | 4000 | IP66 | IK09 | 19.00 | Graphite grey | Dimmable |
| IT3-SV-4.7-9M1F | 175W | LED | 19120 | | 4000 | IP66 | IK09 | 19.00 | Graphite grey | Fixed |
| IT3-SV-4.7-9M1D | 175W | LED | 19120 | | 4000 | IP66 | IK09 | 19.00 | Graphite grey | Dimmable |
| IT3-SV-4.5-10M1F | 142W | LED | 16940 | | 4000 | IP66 | IK09 | 19.00 | Graphite grey | Fixed |
| IT3-SV-4.5-10M1D | 142W | LED | 16940 | | 4000 | IP66 | IK09 | 19.00 | Graphite grey | Dimmable |
| IT3-SV-4.7-10M1F | 194W | LED | 21120 | | 4000 | IP66 | IK09 | 19.00 | Graphite grey | Fixed |
| IT3-SV-4.7-10M1D | 194W | LED | 21120 | | 4000 | IP66 | IK09 | 19.00 | Graphite grey | Dimmable |
| IT3-SV-4.5-11M1F | 157W | LED | 18540 | | 4000 | IP66 | IK09 | 19.00 | Graphite grey | Fixed |
| IT3-SV-4.5-11M1D | 157W | LED | 18540 | | 4000 | IP66 | IK09 | 19.00 | Graphite grey | Dimmable |
| IT3-SV-4.7-11M1F | 213W | LED | 23110 | | 4000 | IP66 | IK09 | 19.00 | Graphite grey | Fixed |
| IT3-SV-4.7-11M1D | 213W | LED | 23110 | | 4000 | IP66 | IK09 | 19.00 | Graphite grey | Dimmable |
| IT3-SV-4.5-12M1F | 173W | LED | 19970 | | 4000 | IP66 | IK09 | 19.00 | Graphite grey | Fixed |
| IT3-SV-4.5-12M1D | 173W | LED | 19970 | | 4000 | IP66 | IK09 | 19.00 | Graphite grey | Dimmable |
| IT3-SV-4.7-12M1F | 232W | LED | 25100 | | 4000 | IP66 | IK09 | 19.00 | Graphite grey | Fixed |
| IT3-SV-4.7-12M1D | 232W | LED | 25100 | | 4000 | IP66 | IK09 | 19.00 | Graphite grey | Dimmable |
| IT3-SV-4.5-13M1F | 188W | LED | 21660 | | 4000 | IP66 | IK09 | 19.00 | Graphite grey | Fixed |
| IT3-SV-4.5-13M1D | 188W | LED | 21660 | | 4000 | IP66 | IK09 | 19.00 | Graphite grey | Dimmable |
| IT3-SV-4.7-13M1F | 249W | LED | 27070 | | 4000 | IP66 | IK09 | 19.00 | Graphite grey | Fixed |
| IT3-SV-4.7-13M1D | 249W | LED | 27070 | | 4000 | IP66 | IK09 | 19.00 | Graphite grey | Dimmable |
| IT3-SV-4.5-14M1F | 201W | LED | 23450 | | 4000 | IP66 | IK09 | 19.00 | Graphite grey | Fixed |
| IT3-SV-4.5-14M1D | 201W | LED | 23450 | | 4000 | IP66 | IK09 | 19.00 | Graphite grey | Dimmable |
| IT3-SV-4.7-14M1F | 267W | LED | 29040 | | 4000 | IP66 | IK09 | 19.00 | Graphite grey | Fixed |
| IT3-SV-4.7-14M1D | 267W | LED | 29040 | 4000 | IP66 | IK09 | 19.00 | Graphite grey | Dimmable | |
| IT3-SV-4.5-15M1F | 215W | LED | 25030 | 4000 | IP66 | IK09 | 19.00 | Graphite grey | Fixed | |
| IT3-SV-4.5-15M1D | 215W | LED | 25030 | 4000 | IP66 | IK09 | 19.00 | Graphite grey | Dimmable | |
| IT3-SV-4.7-15M1F | 286W | LED | 31000 | 4000 | IP66 | IK09 | 19.00 | Graphite grey | Fixed | |
| IT3-SV-4.7-15M1D | 286W | LED | 31000 | 4000 | IP66 | IK09 | 19.00 | Graphite grey | Dimmable | |
| STE-S Optic | | | | | | | | | | |
| IT1-STE-S-4.5-1M1F | 20W | LED | 8210 | Asymmetrical suburban street optic (STE-S) | 4000 | IP66 | IK09 | 6.80 | Graphite grey | Fixed |
| IT1-STE-S-4.5-1M1D | 20W | LED | 8210 | | 4000 | IP66 | IK09 | 6.80 | Graphite grey | Dimmable |
| IT1-STE-S-4.7-1M1F | 28W | LED | 8210 | | 4000 | IP66 | IK09 | 6.80 | Graphite grey | Fixed |
| IT1-STE-S-4.7-1M1D | 28W | LED | 8210 | | 4000 | IP66 | IK09 | 6.80 | Graphite grey | Dimmable |

| Code | Power | Light Source | Luminaire Lumens | Optic | CCT(K) | IP | IK | Weight (kg) | Paint Finish | Product Type |
|---------------------|-------|--------------|------------------|--|--------|------|-------|---------------|---------------|--------------|
| IT1-STE-S-4.5-2M1F | 39.5W | LED | 8210 | Asymmetrical suburban street optic (STE-S) | 4000 | IP66 | IK09 | 6.80 | Graphite grey | Fixed |
| IT1-STE-S-4.5-2M1D | 39.5W | LED | 8210 | | 4000 | IP66 | IK09 | 6.80 | Graphite grey | Dimmable |
| IT1-STE-S-4.7-2M1F | 52W | LED | 8210 | | 4000 | IP66 | IK09 | 6.80 | Graphite grey | Fixed |
| IT1-STE-S-4.7-2M1D | 52W | LED | 8210 | | 4000 | IP66 | IK09 | 6.80 | Graphite grey | Dimmable |
| IT1-STE-S-4.5-3M1F | 58W | LED | 8210 | | 4000 | IP66 | IK09 | 6.80 | Graphite grey | Fixed |
| IT1-STE-S-4.5-3M1D | 58W | LED | 8210 | | 4000 | IP66 | IK09 | 6.80 | Graphite grey | Dimmable |
| IT1-STE-S-4.7-3M1F | 76W | LED | 8210 | | 4000 | IP66 | IK09 | 6.80 | Graphite grey | Fixed |
| IT1-STE-S-4.7-3M1D | 76W | LED | 8210 | | 4000 | IP66 | IK09 | 6.80 | Graphite grey | Dimmable |
| IT1-STE-S-4.5-4M1F | 75W | LED | 8210 | | 4000 | IP66 | IK09 | 6.80 | Graphite grey | Fixed |
| IT1-STE-S-4.5-4M1D | 75W | LED | 8210 | | 4000 | IP66 | IK09 | 6.80 | Graphite grey | Dimmable |
| IT1-STE-S-4.7-4M1F | 102W | LED | 8210 | | 4000 | IP66 | IK09 | 6.80 | Graphite grey | Fixed |
| IT1-STE-S-4.7-4M1D | 102W | LED | 8210 | | 4000 | IP66 | IK09 | 6.80 | Graphite grey | Dimmable |
| IT2-STE-S-4.5-5M1F | 98W | LED | 8210 | | 4000 | IP66 | IK09 | 12.00 | Graphite grey | Fixed |
| IT2-STE-S-4.5-5M1D | 98W | LED | 8210 | | 4000 | IP66 | IK09 | 12.00 | Graphite grey | Dimmable |
| IT2-STE-S-4.7-5M1F | 127W | LED | 8210 | | 4000 | IP66 | IK09 | 12.00 | Graphite grey | Fixed |
| IT2-STE-S-4.7-5M1D | 127W | LED | 8210 | | 4000 | IP66 | IK09 | 12.00 | Graphite grey | Dimmable |
| IT2-STE-S-4.5-6M1F | 115W | LED | 8210 | | 4000 | IP66 | IK09 | 12.00 | Graphite grey | Fixed |
| IT2-STE-S-4.5-6M1D | 115W | LED | 8210 | | 4000 | IP66 | IK09 | 12.00 | Graphite grey | Dimmable |
| IT2-STE-S-4.7-6M1F | 148W | LED | 8210 | | 4000 | IP66 | IK09 | 12.00 | Graphite grey | Fixed |
| IT2-STE-S-4.7-6M1D | 148W | LED | 8210 | | 4000 | IP66 | IK09 | 12.00 | Graphite grey | Dimmable |
| IT2-STE-S-4.5-7M1F | 132W | LED | 8210 | | 4000 | IP66 | IK09 | 12.00 | Graphite grey | Fixed |
| IT2-STE-S-4.5-7M1D | 132W | LED | 8210 | | 4000 | IP66 | IK09 | 12.00 | Graphite grey | Dimmable |
| IT3-STE-S-4.7-7M1F | 183W | LED | 8210 | | 4000 | IP66 | IK09 | 19.00 | Graphite grey | Fixed |
| IT3-STE-S-4.7-7M1D | 183W | LED | 8210 | | 4000 | IP66 | IK09 | 19.00 | Graphite grey | Dimmable |
| IT2-STE-S-4.5-8M1F | 150W | LED | 8210 | | 4000 | IP66 | IK09 | 12.00 | Graphite grey | Fixed |
| IT2-STE-S-4.5-8M1D | 150W | LED | 8210 | | 4000 | IP66 | IK09 | 12.00 | Graphite grey | Dimmable |
| IT3-STE-S-4.7-8M1F | 208W | LED | 8210 | | 4000 | IP66 | IK09 | 19.00 | Graphite grey | Fixed |
| IT3-STE-S-4.7-8M1D | 208W | LED | 8210 | | 4000 | IP66 | IK09 | 19.00 | Graphite grey | Dimmable |
| IT3-STE-S-4.5-9M1F | 173W | LED | 8210 | | 4000 | IP66 | IK09 | 19.00 | Graphite grey | Fixed |
| IT3-STE-S-4.5-9M1D | 173W | LED | 8210 | | 4000 | IP66 | IK09 | 19.00 | Graphite grey | Dimmable |
| IT3-STE-S-4.7-9M1F | 231W | LED | 8210 | | 4000 | IP66 | IK09 | 19.00 | Graphite grey | Fixed |
| IT3-STE-S-4.7-9M1D | 231W | LED | 8210 | | 4000 | IP66 | IK09 | 19.00 | Graphite grey | Dimmable |
| IT3-STE-S-4.5-10M1F | 191W | LED | 8210 | | 4000 | IP66 | IK09 | 19.00 | Graphite grey | Fixed |
| IT3-STE-S-4.5-10M1D | 191W | LED | 8210 | | 4000 | IP66 | IK09 | 19.00 | Graphite grey | Dimmable |
| IT3-STE-S-4.7-10M1F | 253W | LED | 8210 | | 4000 | IP66 | IK09 | 19.00 | Graphite grey | Fixed |
| IT3-STE-S-4.7-10M1D | 253W | LED | 8210 | | 4000 | IP66 | IK09 | 19.00 | Graphite grey | Dimmable |
| IT3-STE-S-4.5-11M1F | 209W | LED | 8210 | | 4000 | IP66 | IK09 | 19.00 | Graphite grey | Fixed |
| IT3-STE-S-4.5-11M1D | 209W | LED | 8210 | | 4000 | IP66 | IK09 | 19.00 | Graphite grey | Dimmable |
| IT3-STE-S-4.7-11M1F | 278W | LED | 8210 | | 4000 | IP66 | IK09 | 19.00 | Graphite grey | Fixed |
| IT3-STE-S-4.7-11M1D | 278W | LED | 8210 | | 4000 | IP66 | IK09 | 19.00 | Graphite grey | Dimmable |
| IT3-STE-S-4.5-12M1F | 228W | LED | 8210 | 4000 | IP66 | IK09 | 19.00 | Graphite grey | Fixed | |
| IT3-STE-S-4.5-12M1D | 228W | LED | 8210 | 4000 | IP66 | IK09 | 19.00 | Graphite grey | Dimmable | |
| IT3-STE-S-4.7-12M1F | 303W | LED | 8210 | 4000 | IP66 | IK09 | 19.00 | Graphite grey | Fixed | |
| IT3-STE-S-4.7-12M1D | 303W | LED | 8210 | 4000 | IP66 | IK09 | 19.00 | Graphite grey | Dimmable | |
| IT3-STE-S-4.5-13M1F | 246W | LED | 8210 | 4000 | IP66 | IK09 | 19.00 | Graphite grey | Fixed | |
| IT3-STE-S-4.5-13M1D | 246W | LED | 8210 | 4000 | IP66 | IK09 | 19.00 | Graphite grey | Dimmable | |
| IT3-STE-S-4.5-14M1F | 263W | LED | 8210 | 4000 | IP66 | IK09 | 19.00 | Graphite grey | Fixed | |
| IT3-STE-S-4.5-14M1D | 263W | LED | 8210 | 4000 | IP66 | IK09 | 19.00 | Graphite grey | Dimmable | |
| IT3-STE-S-4.5-15M1F | 282W | LED | 8210 | 4000 | IP66 | IK09 | 19.00 | Graphite grey | Fixed | |
| IT3-STE-S-4.5-15M1D | 282W | LED | 8210 | 4000 | IP66 | IK09 | 19.00 | Graphite grey | Dimmable | |

| Code | Power | Light Source | Luminaire Lumens | Optic | CCT(K) | IP | IK | Weight (kg) | Paint Finish | Product Type |
|---------------------|-------|--------------|------------------|--|--------|------|-------|---------------|---------------|--------------|
| STE-M Optic | | | | | | | | | | |
| IT1-STE-M-4.5-1M1F | 20W | LED | 2010 | Asymmetrical suburban street optic (STE-M) | 4000 | IP66 | IK09 | 6.80 | Graphite grey | Fixed |
| IT1-STE-M-4.5-1M1D | 20W | LED | 2010 | | 4000 | IP66 | IK09 | 6.80 | Graphite grey | Dimmable |
| IT1-STE-M-4.7-1M1F | 28W | LED | 2800 | | 4000 | IP66 | IK09 | 6.80 | Graphite grey | Fixed |
| IT1-STE-M-4.7-1M1D | 28W | LED | 2800 | | 4000 | IP66 | IK09 | 6.80 | Graphite grey | Dimmable |
| IT1-STE-M-4.5-2M1F | 39.5W | LED | 4570 | | 4000 | IP66 | IK09 | 6.80 | Graphite grey | Fixed |
| IT1-STE-M-4.5-2M1D | 39.5W | LED | 4570 | | 4000 | IP66 | IK09 | 6.80 | Graphite grey | Dimmable |
| IT1-STE-M-4.7-2M1F | 52W | LED | 5730 | | 4000 | IP66 | IK09 | 6.80 | Graphite grey | Fixed |
| IT1-STE-M-4.7-2M1D | 52W | LED | 5730 | | 4000 | IP66 | IK09 | 6.80 | Graphite grey | Dimmable |
| IT1-STE-M-4.5-3M1F | 58W | LED | 6790 | | 4000 | IP66 | IK09 | 6.80 | Graphite grey | Fixed |
| IT1-STE-M-4.5-3M1D | 58W | LED | 6790 | | 4000 | IP66 | IK09 | 6.80 | Graphite grey | Dimmable |
| IT1-STE-M-4.7-3M1F | 76W | LED | 8490 | | 4000 | IP66 | IK09 | 6.80 | Graphite grey | Fixed |
| IT1-STE-M-4.7-3M1D | 76W | LED | 8490 | | 4000 | IP66 | IK09 | 6.80 | Graphite grey | Dimmable |
| IT1-STE-M-4.5-4M1F | 75W | LED | 9030 | | 4000 | IP66 | IK09 | 6.80 | Graphite grey | Fixed |
| IT1-STE-M-4.5-4M1D | 75W | LED | 9030 | | 4000 | IP66 | IK09 | 6.80 | Graphite grey | Dimmable |
| IT1-STE-M-4.7-4M1F | 102W | LED | 11270 | | 4000 | IP66 | IK09 | 6.80 | Graphite grey | Fixed |
| IT1-STE-M-4.7-4M1D | 102W | LED | 11270 | | 4000 | IP66 | IK09 | 6.80 | Graphite grey | Dimmable |
| IT2-STE-M-4.5-5M1F | 98W | LED | 11450 | | 4000 | IP66 | IK09 | 12.00 | Graphite grey | Fixed |
| IT2-STE-M-4.5-5M1D | 98W | LED | 11450 | | 4000 | IP66 | IK09 | 12.00 | Graphite grey | Dimmable |
| IT2-STE-M-4.7-5M1F | 127W | LED | 14110 | | 4000 | IP66 | IK09 | 12.00 | Graphite grey | Fixed |
| IT2-STE-M-4.7-5M1D | 127W | LED | 14110 | | 4000 | IP66 | IK09 | 12.00 | Graphite grey | Dimmable |
| IT2-STE-M-4.5-6M1F | 115W | LED | 13470 | | 4000 | IP66 | IK09 | 12.00 | Graphite grey | Fixed |
| IT2-STE-M-4.5-6M1D | 115W | LED | 13470 | | 4000 | IP66 | IK09 | 12.00 | Graphite grey | Dimmable |
| IT2-STE-M-4.7-6M1F | 148W | LED | 16630 | | 4000 | IP66 | IK09 | 12.00 | Graphite grey | Fixed |
| IT2-STE-M-4.7-6M1D | 148W | LED | 16630 | | 4000 | IP66 | IK09 | 12.00 | Graphite grey | Dimmable |
| IT2-STE-M-4.5-7M1F | 132W | LED | 15400 | | 4000 | IP66 | IK09 | 12.00 | Graphite grey | Fixed |
| IT2-STE-M-4.5-7M1D | 132W | LED | 15400 | | 4000 | IP66 | IK09 | 12.00 | Graphite grey | Dimmable |
| IT3-STE-M-4.7-7M1F | 183W | LED | 19030 | | 4000 | IP66 | IK09 | 19.00 | Graphite grey | Fixed |
| IT3-STE-M-4.7-7M1D | 183W | LED | 19030 | | 4000 | IP66 | IK09 | 19.00 | Graphite grey | Dimmable |
| IT2-STE-M-4.5-8M1F | 150W | LED | 17670 | | 4000 | IP66 | IK09 | 12.00 | Graphite grey | Fixed |
| IT2-STE-M-4.5-8M1D | 150W | LED | 17670 | | 4000 | IP66 | IK09 | 12.00 | Graphite grey | Dimmable |
| IT3-STE-M-4.7-8M1F | 208W | LED | 21740 | | 4000 | IP66 | IK09 | 19.00 | Graphite grey | Fixed |
| IT3-STE-M-4.7-8M1D | 208W | LED | 21740 | | 4000 | IP66 | IK09 | 19.00 | Graphite grey | Dimmable |
| IT3-STE-M-4.5-9M1F | 173W | LED | 19550 | | 4000 | IP66 | IK09 | 19.00 | Graphite grey | Fixed |
| IT3-STE-M-4.5-9M1D | 173W | LED | 19550 | | 4000 | IP66 | IK09 | 19.00 | Graphite grey | Dimmable |
| IT3-STE-M-4.7-9M1F | 231W | LED | 24460 | | 4000 | IP66 | IK09 | 19.00 | Graphite grey | Fixed |
| IT3-STE-M-4.7-9M1D | 231W | LED | 24460 | | 4000 | IP66 | IK09 | 19.00 | Graphite grey | Dimmable |
| IT3-STE-M-4.5-10M1F | 191W | LED | 21850 | 4000 | IP66 | IK09 | 19.00 | Graphite grey | Fixed | |
| IT3-STE-M-4.5-10M1D | 191W | LED | 21850 | 4000 | IP66 | IK09 | 19.00 | Graphite grey | Dimmable | |
| IT3-STE-M-4.7-10M1F | 253W | LED | 26990 | 4000 | IP66 | IK09 | 19.00 | Graphite grey | Fixed | |
| IT3-STE-M-4.7-10M1D | 253W | LED | 26990 | 4000 | IP66 | IK09 | 19.00 | Graphite grey | Dimmable | |
| IT3-STE-M-4.5-11M1F | 209W | LED | 24010 | 4000 | IP66 | IK09 | 19.00 | Graphite grey | Fixed | |
| IT3-STE-M-4.5-11M1D | 209W | LED | 24010 | 4000 | IP66 | IK09 | 19.00 | Graphite grey | Dimmable | |
| IT3-STE-M-4.7-11M1F | 278W | LED | 29550 | 4000 | IP66 | IK09 | 19.00 | Graphite grey | Fixed | |
| IT3-STE-M-4.7-11M1D | 278W | LED | 29550 | 4000 | IP66 | IK09 | 19.00 | Graphite grey | Dimmable | |
| IT3-STE-M-4.5-12M1F | 228W | LED | 26200 | 4000 | IP66 | IK09 | 19.00 | Graphite grey | Fixed | |
| IT3-STE-M-4.5-12M1D | 228W | LED | 26200 | 4000 | IP66 | IK09 | 19.00 | Graphite grey | Dimmable | |
| IT3-STE-M-4.7-12M1F | 303W | LED | 32160 | 4000 | IP66 | IK09 | 19.00 | Graphite grey | Fixed | |
| IT3-STE-M-4.7-12M1D | 303W | LED | 32160 | 4000 | IP66 | IK09 | 19.00 | Graphite grey | Dimmable | |
| IT3-STE-M-4.5-13M1F | 246W | LED | 28370 | 4000 | IP66 | IK09 | 19.00 | Graphite Grey | Fixed | |

| Code | Power | Light Source | Luminaire Lumens | Optic | CCT(K) | IP | IK | Weight (kg) | Paint Finish | Product Type |
|---------------------|-------|--------------|------------------|--|--------|------|-------|---------------|---------------|--------------|
| IT3-STE-M-4.5-13M1D | 246W | LED | 28370 | Asymmetrical suburban street optic (STE-M) | 4000 | IP66 | IK09 | 19.00 | Graphite grey | Dimmable |
| IT3-STE-M-4.5-14M1F | 263W | LED | 30370 | | 4000 | IP66 | IK09 | 19.00 | Graphite grey | Fixed |
| IT3-STE-M-4.5-14M1D | 263W | LED | 30370 | | 4000 | IP66 | IK09 | 19.00 | Graphite grey | Dimmable |
| IT3-STE-M-4.5-15M1F | 282W | LED | 32510 | | 4000 | IP66 | IK09 | 19.00 | Graphite grey | Fixed |
| IT3-STE-M-4.5-15M1D | 282W | LED | 32510 | | 4000 | IP66 | IK09 | 19.00 | Graphite grey | Dimmable |
| STW Optic | | | | | | | | | | |
| IT1-STW-4.5-1M1F | 20W | LED | 2010 | Asymmetrical suburban street optic (STW) | 4000 | IP66 | IK09 | 6.80 | Graphite grey | Fixed |
| IT1-STW-4.5-1M1D | 20W | LED | 2010 | | 4000 | IP66 | IK09 | 6.80 | Graphite grey | Dimmable |
| IT1-STW-4.7-1M1F | 28W | LED | 2800 | | 4000 | IP66 | IK09 | 6.80 | Graphite grey | Fixed |
| IT1-STW-4.7-1M1D | 28W | LED | 2800 | | 4000 | IP66 | IK09 | 6.80 | Graphite grey | Dimmable |
| IT1-STW-4.5-2M1F | 39.5W | LED | 4570 | | 4000 | IP66 | IK09 | 6.80 | Graphite grey | Fixed |
| IT1-STW-4.5-2M1D | 39.5W | LED | 4570 | | 4000 | IP66 | IK09 | 6.80 | Graphite grey | Dimmable |
| IT1-STW-4.7-2M1F | 52W | LED | 5730 | | 4000 | IP66 | IK09 | 6.80 | Graphite grey | Fixed |
| IT1-STW-4.7-2M1D | 52W | LED | 5730 | | 4000 | IP66 | IK09 | 6.80 | Graphite grey | Dimmable |
| IT1-STW-4.5-3M1F | 58W | LED | 6790 | | 4000 | IP66 | IK09 | 6.80 | Graphite grey | Fixed |
| IT1-STW-4.5-3M1D | 58W | LED | 6790 | | 4000 | IP66 | IK09 | 6.80 | Graphite grey | Dimmable |
| IT1-STW-4.7-3M1F | 76W | LED | 8490 | | 4000 | IP66 | IK09 | 6.80 | Graphite grey | Fixed |
| IT1-STW-4.7-3M1D | 76W | LED | 8490 | | 4000 | IP66 | IK09 | 6.80 | Graphite grey | Dimmable |
| IT1-STW-4.5-4M1F | 75W | LED | 9030 | | 4000 | IP66 | IK09 | 6.80 | Graphite grey | Fixed |
| IT1-STW-4.5-4M1D | 75W | LED | 9030 | | 4000 | IP66 | IK09 | 6.80 | Graphite grey | Dimmable |
| IT1-STW-4.7-4M1F | 102W | LED | 11270 | | 4000 | IP66 | IK09 | 6.80 | Graphite grey | Fixed |
| IT1-STW-4.7-4M1D | 102W | LED | 11270 | | 4000 | IP66 | IK09 | 6.80 | Graphite grey | Dimmable |
| IT2-STW-4.5-5M1F | 98W | LED | 11450 | | 4000 | IP66 | IK09 | 12.00 | Graphite grey | Fixed |
| IT2-STW-4.5-5M1D | 98W | LED | 11450 | | 4000 | IP66 | IK09 | 12.00 | Graphite grey | Dimmable |
| IT2-STW-4.7-5M1F | 127W | LED | 14110 | | 4000 | IP66 | IK09 | 12.00 | Graphite grey | Fixed |
| IT2-STW-4.7-5M1D | 127W | LED | 14110 | | 4000 | IP66 | IK09 | 12.00 | Graphite grey | Dimmable |
| IT2-STW-4.5-6M1F | 115W | LED | 13470 | | 4000 | IP66 | IK09 | 12.00 | Graphite grey | Fixed |
| IT2-STW-4.5-6M1D | 115W | LED | 13470 | | 4000 | IP66 | IK09 | 12.00 | Graphite grey | Dimmable |
| IT2-STW-4.7-6M1F | 148W | LED | 16630 | | 4000 | IP66 | IK09 | 12.00 | Graphite grey | Fixed |
| IT2-STW-4.7-6M1D | 148W | LED | 16630 | | 4000 | IP66 | IK09 | 12.00 | Graphite grey | Dimmable |
| IT2-STW-4.5-7M1F | 132W | LED | 15400 | | 4000 | IP66 | IK09 | 12.00 | Graphite grey | Fixed |
| IT2-STW-4.5-7M1D | 132W | LED | 15400 | | 4000 | IP66 | IK09 | 12.00 | Graphite grey | Dimmable |
| IT3-STW-4.7-7M1F | 183W | LED | 19030 | | 4000 | IP66 | IK09 | 19.00 | Graphite grey | Fixed |
| IT3-STW-4.7-7M1D | 183W | LED | 19030 | 4000 | IP66 | IK09 | 19.00 | Graphite grey | Dimmable | |
| IT2-STW-4.5-8M1F | 150W | LED | 17670 | 4000 | IP66 | IK09 | 12.00 | Graphite grey | Fixed | |
| IT2-STW-4.5-8M1D | 150W | LED | 17670 | 4000 | IP66 | IK09 | 12.00 | Graphite grey | Dimmable | |
| IT3-STW-4.7-8M1F | 208W | LED | 21740 | 4000 | IP66 | IK09 | 19.00 | Graphite grey | Fixed | |
| IT3-STW-4.7-8M1D | 208W | LED | 21740 | 4000 | IP66 | IK09 | 19.00 | Graphite grey | Dimmable | |
| IT3-STW-4.5-9M1F | 173W | LED | 19550 | 4000 | IP66 | IK09 | 19.00 | Graphite grey | Fixed | |
| IT3-STW-4.5-9M1D | 173W | LED | 19550 | 4000 | IP66 | IK09 | 19.00 | Graphite grey | Dimmable | |
| IT3-STW-4.7-9M1F | 231W | LED | 24460 | 4000 | IP66 | IK09 | 19.00 | Graphite grey | Fixed | |
| IT3-STW-4.7-9M1D | 231W | LED | 24460 | 4000 | IP66 | IK09 | 19.00 | Graphite grey | Dimmable | |
| IT3-STW-4.5-10M1F | 191W | LED | 21850 | 4000 | IP66 | IK09 | 19.00 | Graphite grey | Fixed | |
| IT3-STW-4.5-10M1D | 191W | LED | 21850 | 4000 | IP66 | IK09 | 19.00 | Graphite grey | Dimmable | |
| IT3-STW-4.7-10M1F | 253W | LED | 26990 | 4000 | IP66 | IK09 | 19.00 | Graphite grey | Fixed | |
| IT3-STW-4.7-10M1D | 253W | LED | 26990 | 4000 | IP66 | IK09 | 19.00 | Graphite grey | Dimmable | |
| IT3-STW-4.5-11M1F | 209W | LED | 24010 | 4000 | IP66 | IK09 | 19.00 | Graphite grey | Fixed | |
| IT3-STW-4.5-11M1D | 209W | LED | 24010 | 4000 | IP66 | IK09 | 19.00 | Graphite grey | Dimmable | |
| IT3-STW-4.7-11M1F | 278W | LED | 29550 | 4000 | IP66 | IK09 | 19.00 | Graphite grey | Fixed | |
| IT3-STW-4.7-11M1D | 278W | LED | 29550 | 4000 | IP66 | IK09 | 19.00 | Graphite grey | Dimmable | |

| Code | Power | Light Source | Luminaire Lumens | Optic | CCT(K) | IP | IK | Weight (kg) | Paint Finish | Product Type |
|-------------------|-------|--------------|------------------|--|--------|------|------|-------------|---------------|--------------|
| IT3-STW-4.5-12M1F | 228W | LED | 26200 | Asymmetrical suburban street optic (STW) | 4000 | IP66 | IK09 | 19.00 | Graphite grey | Fixed |
| IT3-STW-4.5-12M1D | 228W | LED | 26200 | | 4000 | IP66 | IK09 | 19.00 | Graphite grey | Dimmable |
| IT3-STW-4.7-12M1F | 303W | LED | 32160 | | 4000 | IP66 | IK09 | 19.00 | Graphite grey | Fixed |
| IT3-STW-4.7-12M1D | 303W | LED | 32160 | | 4000 | IP66 | IK09 | 19.00 | Graphite grey | Dimmable |
| IT3-STW-4.5-13M1F | 246W | LED | 28370 | | 4000 | IP66 | IK09 | 19.00 | Graphite grey | Fixed |
| IT3-STW-4.5-13M1D | 246W | LED | 28370 | | 4000 | IP66 | IK09 | 19.00 | Graphite grey | Dimmable |
| IT3-STW-4.5-14M1F | 263W | LED | 30370 | | 4000 | IP66 | IK09 | 19.00 | Graphite grey | Fixed |
| IT3-STW-4.5-14M1D | 263W | LED | 30370 | | 4000 | IP66 | IK09 | 19.00 | Graphite grey | Dimmable |
| IT3-STW-4.5-15M1F | 282W | LED | 32510 | | 4000 | IP66 | IK09 | 19.00 | Graphite grey | Fixed |
| IT3-STW-4.5-15M1D | 282W | LED | 32510 | | 4000 | IP66 | IK09 | 19.00 | Graphite grey | Dimmable |

Accessories / Options

| | |
|---|--------------------------------|
| Paint finish options | Contact us for details |
| Colour temperature options | 3000K - Contact us for details |
| Photocell option | Contact us for details |
| NEMA socket option | Contact us for details |
| Post-top brackets / spigot size options | Contact us for details |
| Fixed or dimmable | See specification table |

CLIMATE EXTRA LED ARRAY

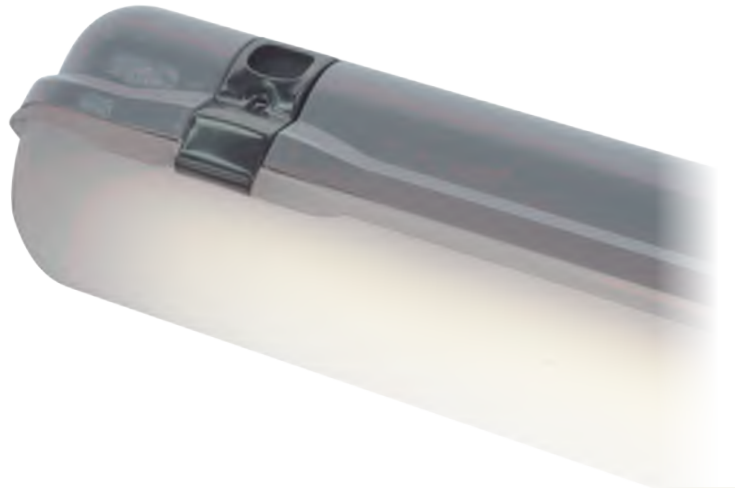

- Increased performance for greater savings
- Opal Diffuser for improved appearance and uniformity
- Polycarbonate construction
- Stainless steel mounting clips
- Stainless steel anti-tamper diffuser clips
- Integral Microwave sensor available in on/off or 10% corridor function
- Also available with batten fit PIR sensors

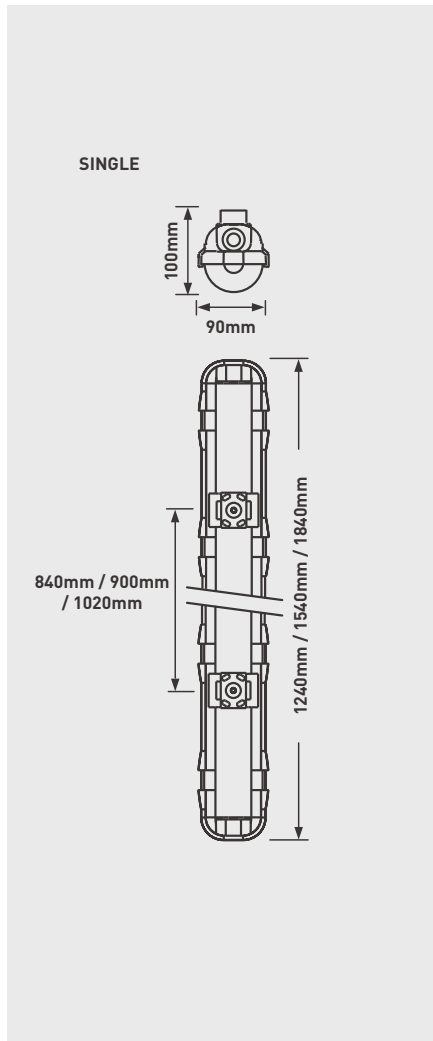

SINGLE

| CAT NO. | DRIVER | SIZE | LUMINAIRE LUMENS | WATTAGE | EFFICACY Llm/W |
|----------------|------------------------------------|--------------|------------------|---------|----------------|
| LCL12022S40 | Standard | 4ft / 1240mm | 2200 | 16W | 138 |
| LCL12022E40 | Emergency | 4ft / 1240mm | 2200 | 16W | 138 |
| LCL12022D40 | Digital Dimmable | 4ft / 1240mm | 2200 | 16W | 138 |
| LCL12022ED40 | Emergency Digital Dimmable | 4ft / 1240mm | 2200 | 16W | 138 |
| LCL12022S40MW | Microwave | 4ft / 1240mm | 2200 | 16W | 138 |
| LCL12022E40MW | Emergency Microwave | 4ft / 1240mm | 2200 | 16W | 138 |
| LCL12022D40MW | Microwave 10% Corridor Function | 4ft / 1240mm | 2200 | 16W | 138 |
| LCL12022ED40MW | Emergency MW 10% Corridor Function | 4ft / 1240mm | 2200 | 16W | 138 |
| LCL15034S40 | Standard | 5ft / 1540mm | 3400 | 24W | 142 |
| LCL15034E40 | Emergency | 5ft / 1540mm | 3400 | 24W | 142 |
| LCL15034D40 | Digital Dimmable | 5ft / 1540mm | 3400 | 24W | 142 |
| LCL15034ED40 | Emergency Digital Dimmable | 5ft / 1540mm | 3400 | 24W | 142 |
| LCL15034S40MW | Microwave | 5ft / 1540mm | 3400 | 24W | 142 |
| LCL15034E40MW | Emergency Microwave | 5ft / 1540mm | 3400 | 24W | 142 |
| LCL15034D40MW | Microwave 10% Corridor Function | 5ft / 1540mm | 3400 | 24W | 142 |
| LCL15034ED40MW | Emergency MW 10% Corridor Function | 5ft / 1540mm | 3400 | 24W | 142 |
| LCL18044S40 | Standard | 6ft / 1840mm | 4400 | 33W | 133 |
| LCL18044E40 | Emergency | 6ft / 1840mm | 4400 | 33W | 133 |
| LCL18044D40 | Digital Dimmable | 6ft / 1840mm | 4400 | 33W | 133 |
| LCL18044ED40 | Emergency Digital Dimmable | 6ft / 1840mm | 4400 | 33W | 133 |
| LCL18044S40MW | Microwave | 6ft / 1840mm | 4400 | 33W | 133 |
| LCL18044E40MW | Digital Microwave Dimmable | 6ft / 1840mm | 4400 | 33W | 133 |
| LCL18044D40MW | Microwave 10% Corridor Function | 6ft / 1840mm | 4400 | 33W | 133 |
| LCL18044ED40MW | Emergency MW 10% Corridor Function | 6ft / 1840mm | 4400 | 33W | 133 |

CLIMATE EXTRA LED ARRAY

- Increased performance for greater savings
- Opal Diffuser for improved appearance and uniformity
- Polycarbonate construction
- Stainless steel mounting clips
- Stainless steel anti-tamper diffuser clips
- Integral Microwave sensor available in on/off or 10% corridor function
- Also available with batten fit PIR sensors

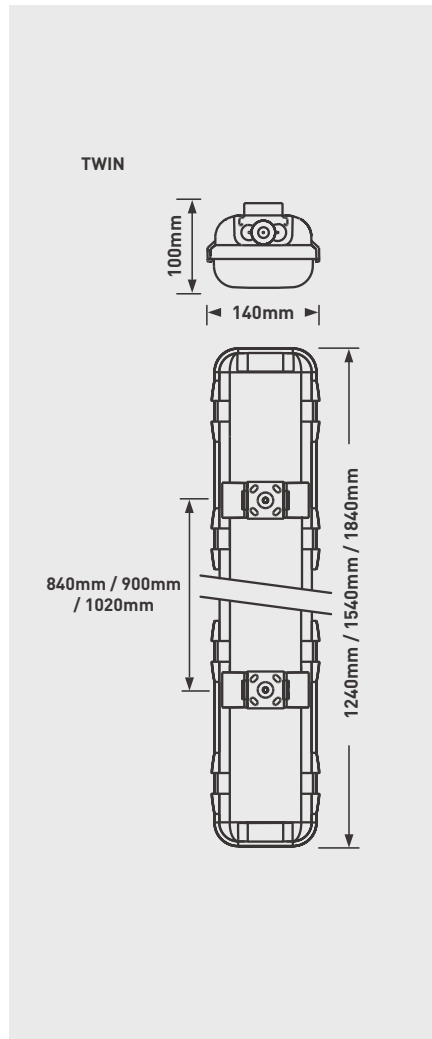

TWIN

| CAT NO. | DRIVER | SIZE | LUMINAIRE LUMENS | WATTAGE | EFFICACY Lm/W |
|----------------|------------------------------------|--------------|------------------|---------|---------------|
| LCL12044S40 | Standard | 4ft / 1240mm | 4400 | 31W | 142 |
| LCL12044E40 | Emergency | 4ft / 1240mm | 4400 | 31W | 142 |
| LCL12044D40 | Digital Dimmable | 4ft / 1240mm | 4400 | 31W | 142 |
| LCL12044ED40 | Emergency Digital Dimmable | 4ft / 1240mm | 4400 | 31W | 142 |
| LCL12044S40MW | Microwave | 4ft / 1240mm | 4400 | 31W | 142 |
| LCL12044E40MW | Emergency Microwave | 4ft / 1240mm | 4400 | 31W | 142 |
| LCL12044D40MW | Microwave 10% Corridor Function | 4ft / 1240mm | 4400 | 31W | 142 |
| LCL12044ED40MW | Emergency MW 10% Corridor Function | 4ft / 1240mm | 4400 | 31W | 142 |
| LCL15066S40 | Standard | 5ft / 1540mm | 6600 | 48W | 138 |
| LCL15066E40 | Emergency | 5ft / 1540mm | 6600 | 48W | 138 |
| LCL15066D40 | Digital Dimmable | 5ft / 1540mm | 6600 | 48W | 138 |
| LCL15066ED40 | Emergency Digital Dimmable | 5ft / 1540mm | 6600 | 48W | 138 |
| LCL15066S40MW | Microwave | 5ft / 1540mm | 6600 | 48W | 138 |
| LCL15066E40MW | Emergency Microwave | 5ft / 1540mm | 6600 | 48W | 138 |
| LCL15066D40MW | Microwave 10% Corridor Function | 5ft / 1540mm | 6600 | 48W | 138 |
| LCL15066ED40MW | Emergency MW 10% Corridor Function | 5ft / 1540mm | 6600 | 48W | 138 |
| LCL18087S40 | Standard | 6ft / 1840mm | 8700 | 66W | 132 |
| LCL18087E40 | Emergency | 6ft / 1840mm | 8700 | 66W | 132 |
| LCL18087D40 | Digital Dimmable | 6ft / 1840mm | 8700 | 66W | 132 |
| LCL18087ED40 | Emergency Digital Dimmable | 6ft / 1840mm | 8700 | 66W | 132 |
| LCL18087S40MW | Microwave | 6ft / 1840mm | 8700 | 66W | 132 |
| LCL18087E40MW | Digital Microwave Dimmable | 6ft / 1840mm | 8700 | 66W | 132 |
| LCL18087D40MW | Microwave 10% Corridor Function | 6ft / 1840mm | 8700 | 66W | 132 |
| LCL18087ED40MW | Emergency MW 10% Corridor Function | 6ft / 1840mm | 8700 | 66W | 132 |

LCL12022S40

LUMINAIRE PERFORMANCE

Light Output Ratio: 99.9%
 Luminaire Efficacy: 134.38 lm/W
 Light Distribution: B31 ↓88.6% ↑11.4%
 CIE Flux Codes: 40 69 88 89 100

LCL15044S40

LUMINAIRE PERFORMANCE

Light Output Ratio: 99.9%
 Luminaire Efficacy: 141.64 lm/W
 Light Distribution: A31 ↓91.5% ↑8.5%
 CIE Flux Codes: 43 73 91 92 100

LCL15034S40

LUMINAIRE PERFORMANCE

Light Output Ratio: 99.9%
 Luminaire Efficacy: 138.47 lm/W
 Light Distribution: B31 ↓89.4% ↑10.6%
 CIE Flux Codes: 40 69 89 89 100

LUMINOUS INTENSITY

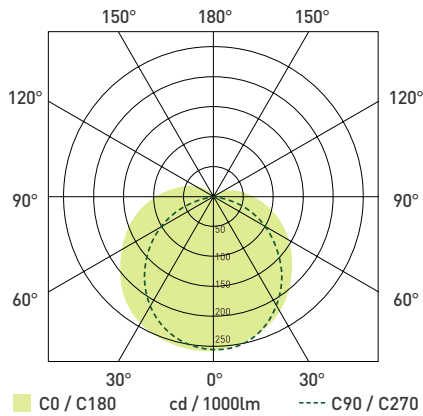

LUMINOUS INTENSITY

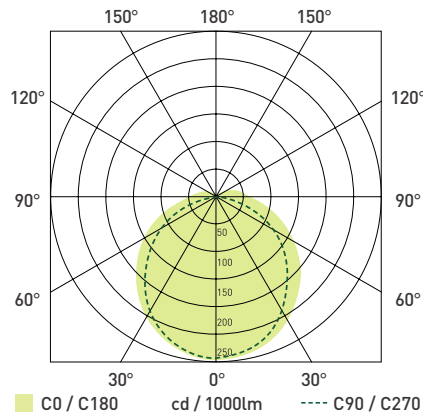

LUMINOUS INTENSITY

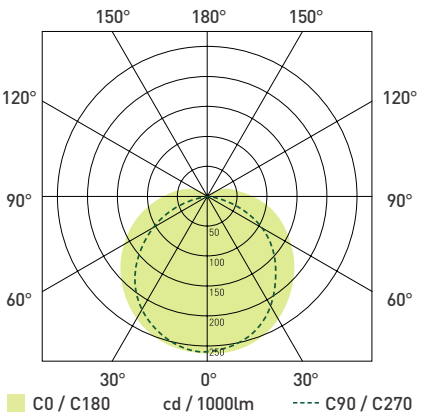

LCL15066S40

LUMINAIRE PERFORMANCE

Light Output Ratio: 99.9%
 Luminaire Efficacy: 139.02 lm/W
 Light Distribution: A31 ↓91.9% ↑8.1%
 CIE Flux Codes: 43 73 91 92 100

LCL18044S40

LUMINAIRE PERFORMANCE

Light Output Ratio: 99.9%
 Luminaire Efficacy: 134.42 lm/W
 Light Distribution: B31 ↓88.3% ↑11.7%
 CIE Flux Codes: 39 68 88 88 100

LCL18087S40

LUMINAIRE PERFORMANCE

Light Output Ratio: 100.0%
 Luminaire Efficacy: 147.93 lm/W
 Light Distribution: A41 ↓97.1% ↑2.9%
 CIE Flux Codes: 46 77 95 97 100

LUMINOUS INTENSITY

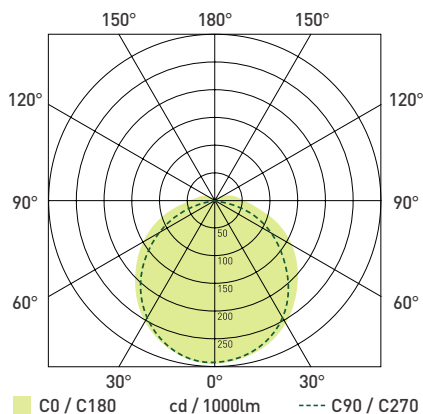

LUMINOUS INTENSITY

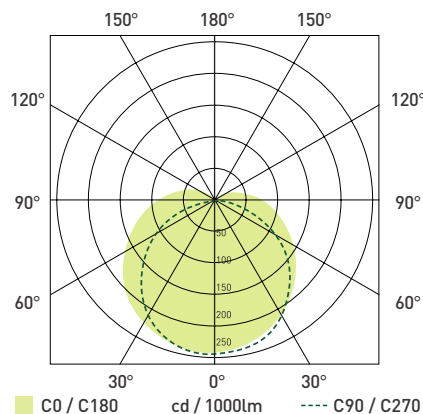

LUMINOUS INTENSITY

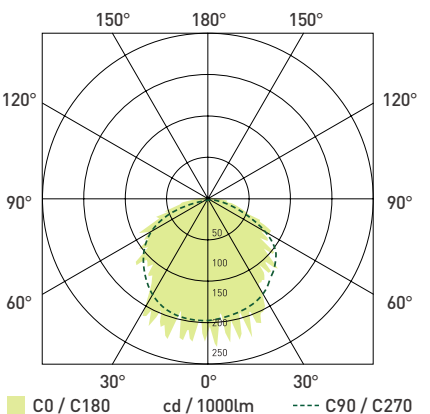

| | LENGTH / DIA (mm) | WIDTH (mm) | HEIGHT / DEPTH (mm) | WEIGHT (kg) | L FIXING CENTRES (mm) | W FIXING CENTRES (mm) | CEILING CUTOUT (mm) | LUMINAIRE LUMENS (Lum) | LUMINAIRE WATTAGE (W) | EFFICACY (Lum/W) | CCCT (K) | CRI | UGR | IP RATED | IK RATED | GLOW WIRE (°C) | RAL COLOUR | TEMP RANGE (°C) | RATED LIFE (HR) | AMBIENT TEMP. RATED LIFE (°C) | L AT RATED LIFE | B AT RATED LIFE | VOLTAGE RANGE | FREQUENCY | EMERGENCY PACK CODE | WARRANTY (YEARS) |
|----------------|-------------------|------------|---------------------|-------------|-----------------------|-----------------------|---------------------|------------------------|-----------------------|------------------|----------|-----|-----|----------|----------|----------------|------------|-----------------|-----------------|-------------------------------|-----------------|-----------------|---------------|-----------|---------------------|------------------|
| LCL12044S40 | 1240 | 140 | 100 | 3.3 | 840 | N/A | N/A | 4400 | 31 | 142 | 4000 | >80 | ≤24 | IP65 | IK08 | 650 | Grey/Opal | -20 to +30 | 50,000 | 25 | 70 | 10 | 110-277V | 50hz | N/A | 3 |
| LCL12044E40 | 1240 | 140 | 100 | 4 | 840 | N/A | N/A | 4400 | 31 | 142 | 4000 | >80 | ≤24 | IP65 | IK08 | 650 | Grey/Opal | 0 +30 | 50,000 | 25 | 70 | 10 | 220-240V | 50hz | N/A | 3 |
| LCL12044D40 | 1240 | 140 | 100 | 3 | 840 | N/A | N/A | 4400 | 31 | 142 | 4000 | >80 | ≤24 | IP65 | IK08 | 650 | Grey/Opal | -20 to +30 | 50,000 | 25 | 70 | 10 | 110-277V | 50hz | N/A | 3 |
| LCL12044ED40 | 1240 | 140 | 100 | 4.2 | 840 | N/A | N/A | 4400 | 31 | 142 | 4000 | >80 | ≤24 | IP65 | IK08 | 650 | Grey/Opal | 0 +30 | 50,000 | 25 | 70 | 10 | 220-240V | 50hz | N/A | 3 |
| LCL12044S40MW | 1240 | 140 | 100 | 3.5 | 840 | N/A | N/A | 4400 | 31 | 142 | 4000 | >80 | ≤24 | IP65 | IK08 | 650 | Grey/Opal | -20 to +30 | 50,000 | 25 | 70 | 10 | 110-277V | 50hz | N/A | 3 |
| LCL12044E40MW | 1240 | 140 | 100 | 4.7 | 840 | N/A | N/A | 4400 | 31 | 142 | 4000 | >80 | ≤24 | IP65 | IK08 | 650 | Grey/Opal | 0 +30 | 50,000 | 25 | 70 | 10 | 110-277V | 50hz | N/A | 3 |
| LCL12044D40MW | 1240 | 140 | 100 | 3.5 | 840 | N/A | N/A | 4400 | 31 | 142 | 4000 | >80 | ≤24 | IP65 | IK08 | 650 | Grey/Opal | -20 to +30 | 50,000 | 25 | 70 | 10 | 110-277V | 50hz | N/A | 3 |
| LCL12044ED40MW | 1240 | 140 | 100 | 4.7 | 840 | N/A | N/A | 4400 | 31 | 142 | 4000 | >80 | ≤24 | IP65 | IK08 | 650 | Grey/Opal | 0 +30 | 50,000 | 25 | 70 | 10 | 110-277V | 50hz | N/A | 3 |
| LCL15066S40 | 1540 | 140 | 100 | 3.7 | 900 | N/A | N/A | 6600 | 48 | 138 | 4000 | >80 | ≤25 | IP65 | IK08 | 650 | Grey/Opal | -20 to +30 | 50,000 | 25 | 70 | 10 | 110-277V | 50hz | N/A | 3 |
| LCL15066E40 | 1540 | 140 | 100 | 4.9 | 900 | N/A | N/A | 6600 | 48 | 138 | 4000 | >80 | ≤25 | IP65 | IK08 | 650 | Grey/Opal | 0 +30 | 50,000 | 25 | 70 | 10 | 110-277V | 50hz | N/A | 3 |
| LCL15066D40 | 1540 | 140 | 100 | 3.7 | 900 | N/A | N/A | 6600 | 48 | 138 | 4000 | >80 | ≤25 | IP65 | IK08 | 650 | Grey/Opal | -20 to +30 | 50,000 | 25 | 70 | 10 | 110-277V | 50hz | N/A | 3 |
| LCL15066ED40 | 1540 | 140 | 100 | 4.9 | 900 | N/A | N/A | 6600 | 48 | 138 | 4000 | >80 | ≤25 | IP65 | IK08 | 650 | Grey/Opal | 0 +30 | 50,000 | 25 | 70 | 10 | 110-277V | 50hz | N/A | 3 |
| LCL15066S40MW | 1540 | 140 | 100 | 4.2 | 900 | N/A | N/A | 6600 | 48 | 138 | 4000 | >80 | ≤25 | IP65 | IK08 | 650 | Grey/Opal | -20 to +30 | 50,000 | 25 | 70 | 10 | 110-277V | 50hz | N/A | 3 |
| LCL15066E40MW | 1540 | 140 | 100 | 5.4 | 900 | N/A | N/A | 6600 | 48 | 138 | 4000 | >80 | ≤25 | IP65 | IK08 | 650 | Grey/Opal | 0 +30 | 50,000 | 25 | 70 | 10 | 110-277V | 50hz | N/A | 3 |
| LCL15066D40MW | 1540 | 140 | 100 | 4.2 | 900 | N/A | N/A | 6600 | 48 | 138 | 4000 | >80 | ≤25 | IP65 | IK08 | 650 | Grey/Opal | -20 to +30 | 50,000 | 25 | 70 | 10 | 110-277V | 50hz | N/A | 3 |
| LCL15066ED40MW | 1540 | 140 | 100 | 5.4 | 900 | N/A | N/A | 6600 | 48 | 138 | 4000 | >80 | ≤25 | IP65 | IK08 | 650 | Grey/Opal | 0 +30 | 50,000 | 25 | 70 | 10 | 110-277V | 50hz | N/A | 3 |
| LCL18087S40 | 1840 | 140 | 100 | 4.4 | 1020 | N/A | N/A | 8700 | 66 | 132 | 4000 | >80 | ≤26 | IP65 | IK08 | 650 | Grey/Opal | -20 to +30 | 50,000 | 25 | 70 | 10 | 110-277V | 50hz | N/A | 3 |
| LCL18087E40 | 1840 | 140 | 100 | 5.2 | 1020 | N/A | N/A | 8700 | 66 | 132 | 4000 | >80 | ≤26 | IP65 | IK08 | 650 | Grey/Opal | 0 +30 | 50,000 | 25 | 70 | 10 | 110-277V | 50hz | N/A | 3 |
| LCL18087D40 | 1840 | 140 | 100 | 4.4 | 1020 | N/A | N/A | 8700 | 66 | 132 | 4000 | >80 | ≤26 | IP65 | IK08 | 650 | Grey/Opal | -20 to +30 | 50,000 | 25 | 70 | 10 | 110-277V | 50hz | N/A | 3 |
| LCL18087ED40 | 1840 | 140 | 100 | 5.2 | 1020 | N/A | N/A | 8700 | 66 | 132 | 4000 | >80 | ≤26 | IP65 | IK08 | 650 | Grey/Opal | 0 +30 | 50,000 | 25 | 70 | 10 | 110-277V | 50hz | N/A | 3 |
| LCL18087S40MW | 1840 | 140 | 100 | 4.6 | 1020 | N/A | N/A | 8700 | 66 | 132 | 4000 | >80 | ≤26 | IP65 | IK08 | 650 | Grey/Opal | -20 to +30 | 50,000 | 25 | 70 | 10 | 110-277V | 50hz | N/A | 3 |
| LCL18087E40MW | 1840 | 140 | 100 | 5.4 | 1020 | N/A | N/A | 8700 | 66 | 132 | 4000 | >80 | ≤26 | IP65 | IK08 | 650 | Grey/Opal | 0 +30 | 50,000 | 25 | 70 | 10 | 110-277V | 50hz | N/A | 3 |
| LCL18087D40MW | 1840 | 140 | 100 | 5.6 | 1020 | N/A | N/A | 8700 | 66 | 132 | 4000 | >80 | ≤26 | IP65 | IK08 | 650 | Grey/Opal | -20 to +30 | 50,000 | 25 | 70 | 10 | 110-277V | 50hz | N/A | 3 |
| LCL18087ED40MW | 1840 | 140 | 100 | 5.6 | 1020 | N/A | N/A | 8700 | 66 | 132 | 4000 | >80 | ≤26 | IP65 | IK08 | 650 | Grey/Opal | 0 +30 | 50,000 | 25 | 70 | 10 | 110-277V | 50hz | N/A | 3 |

LUCECO



This luminaire contains built-in LED lamps.



LED

The lamps cannot be changed in the luminaire.

874/2012 

STANDARDS

| | |
|-------------------|---|
| EN 60598-1 | Luminaires - General requirements |
| EN 60598-2-1 | Luminaires - Fixed general purpose |
| EN 60598-2-22 | Luminaires - Emergency |
| EN 61347-1 | Lamp controlgear - Part 1: General and safety requirements |
| EN 61347-2-13 | Lamp controlgear - Part 2-13 : Particular requirements for d.c. or a.c. supplied electronic controlgear for LED modules |
| EN 55015 | Limits and methods of measurement of radio disturbance characteristics of electrical lighting and similar equipment |
| EN 61547 | Equipment for general lighting purposes - EMC immunity requirements |
| EN 61000-3-2 | Electromagnetic compatibility (EMC) - Part 3-2: Limits - for harmonic current emissions |
| EN 62471 | Photobiological safety of lamps and lamp systems |
| 2002/96/EC | Waste Electrical & Electronic Equipment (WEEE) |
| 2011/65/EU | Restriction of the use of certain Hazardous Substances in EEE (RoHS) |
| (EC) No 1907/2006 | The Registration, Evaluation, Authorisation and Restriction of Chemicals (REACH) |

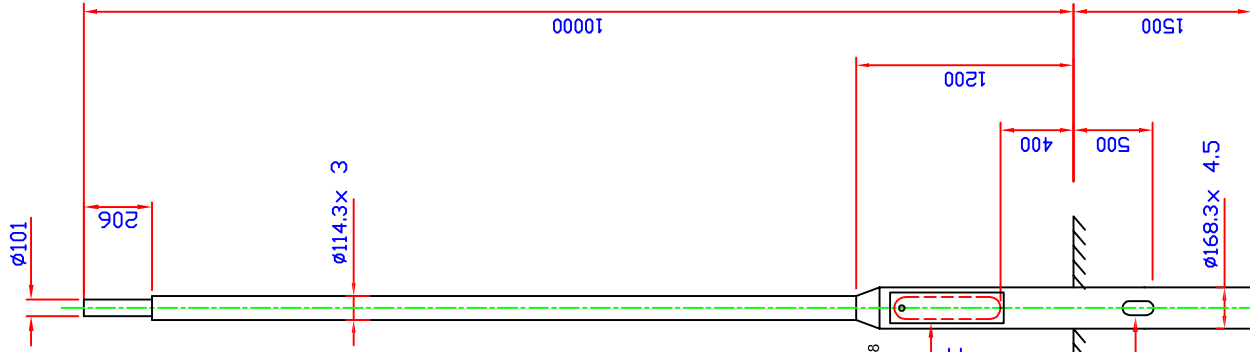

DOOR c/w EARTH TAG & M8 BRASS EARTH BOLT, NUT & 2 WASHERS

BASE COMPARTMENT:
EARTH CLIP & M8 BRASS EARTH BOLT, NUT & 2 WASHERS
HARDWOOD BACKBOARD 686 x 108

DOOR APERTURE
600 x 115

CABLE SLOT
150 x 75

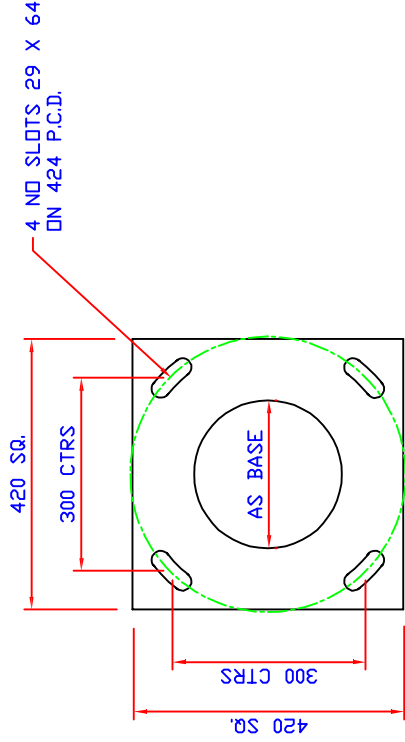

FLANGE PLATE DETAIL

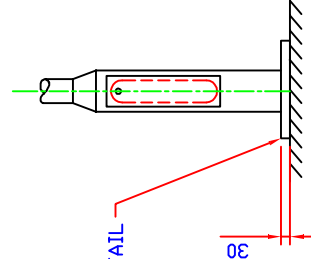

SEE FLANGE PLATE DETAIL

| | | | |
|--|--|---|---------------------|
| Detail of change: | | Title: 10CT114 Column | |
| Detail of change: | | Drawn: R/JH | Drawing No: KL 3179 |
| Detail of change: | | Date: 30/09/2008 | Issue: B |
| Detail of change: | | Material: | |
| A Updated to current spec 30-09-2008 RH | | All dimensions in mm (unless otherwise stated) | |
| © ALL RIGHTS RESERVED KINGFISHER LIGHTING LTD 2008 | |  KINGFISHER LIGHTING LTD RATCHER WAY WILSON INDUSTRIAL PARK MANSFIELD NOTTINGHAMSHIRE NG18 0PS | |